



Concealed Closer - ITS.11205 Fitting Instruction

TEL: +44 (0) 1246 261 491 | www.rutlanduk.co.uk



Operations and Maintenance Manual

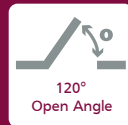

UK
CA
1720

BS EN 1154

4 8 2/5 1 1 3

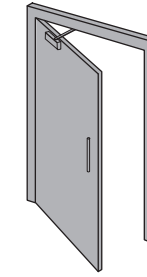

Fire Doors

Use in conjunction with the IP.115 Intumescent kit + Fitting Instruction

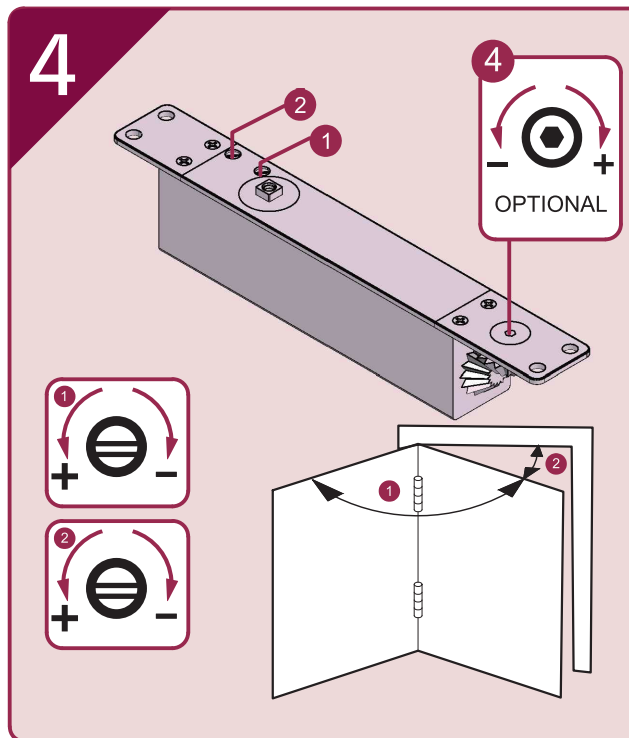
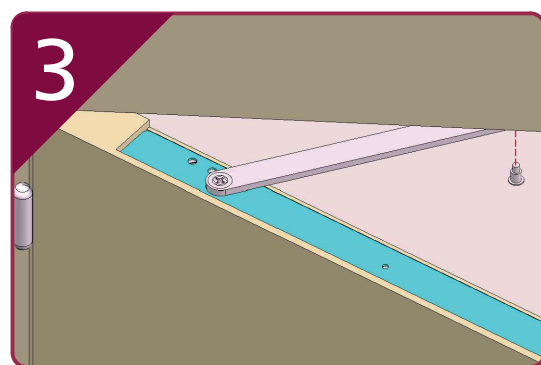
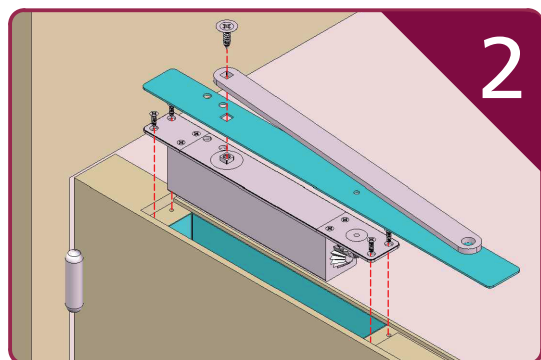
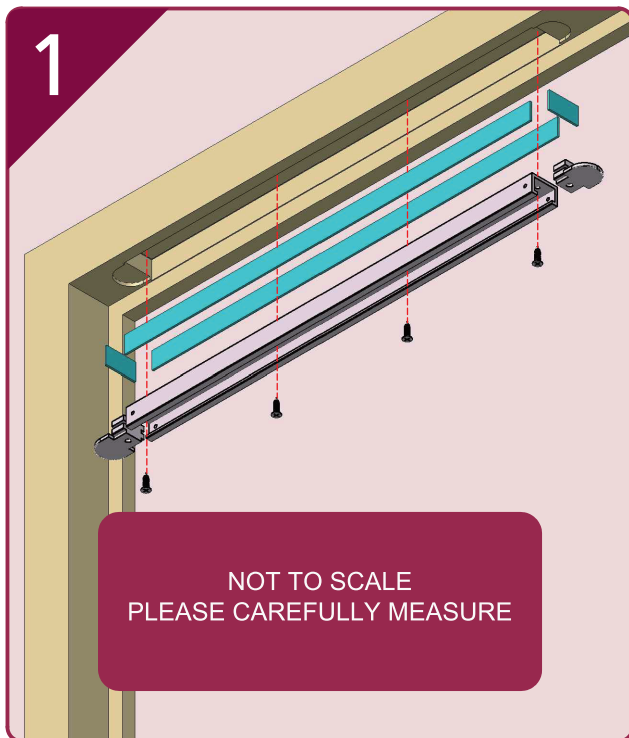
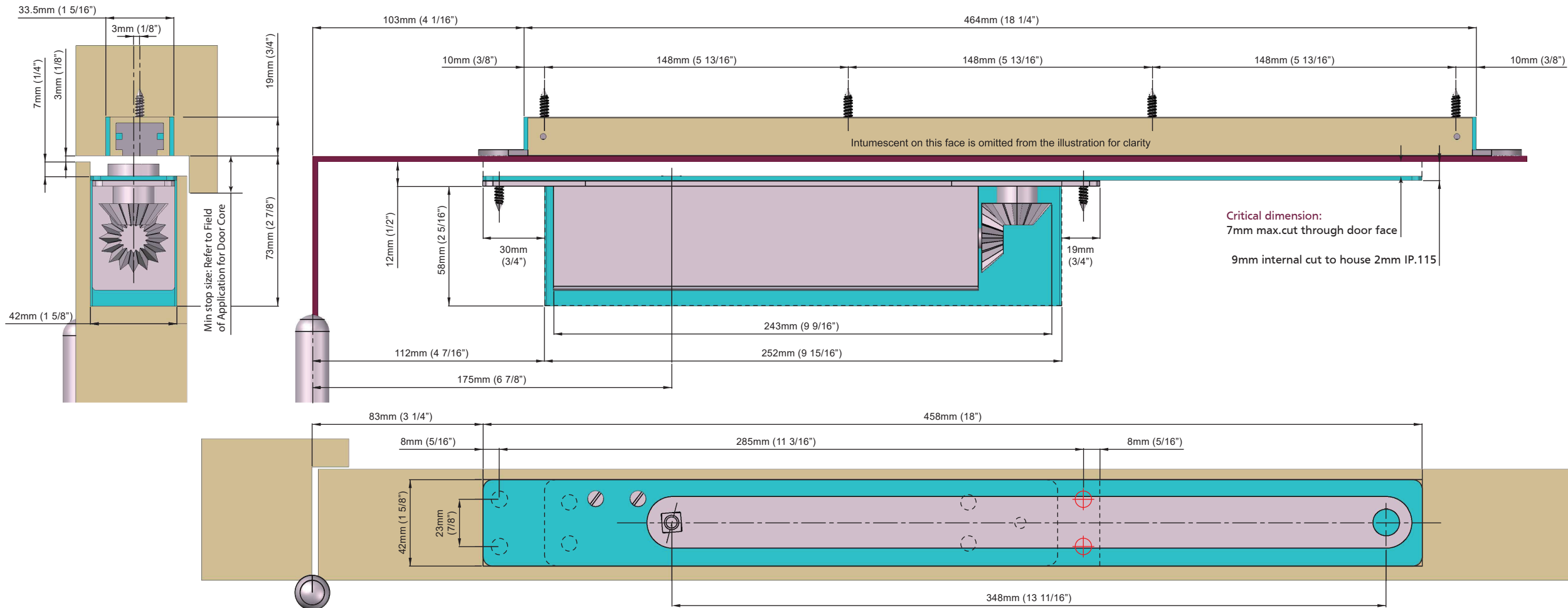

2-5 Door Closer adjustments

No. of turns	Size	Max. door width	Max. opening angle	Max weight
-3	2	850mm	110°	45
*0	3	950mm	110°	60
+3	4	1100mm	110°	80
+5	5	1250mm	110°	110

* FACTORY PRE-SET
CE in size EN3-5only

IMPORTANT NOTES:
FOR UNINSULATED STEEL DOORS IP.95M MUST BE USED.
THE PINION BOLT MUST BE TIGHTENED TO 12Nm.

A MECHANICAL DOOR CLOSER IS NOT DESIGNED TO OVERCOME POOR FITTING, EXCESSIVE AIR PRESSURES OR BINDING SMOKE AND WEATHER SEALS. EXCESSIVE AIR PRESSURES CAN BE CREATED BY THROUGH DRAFT, BY AIR CONDITIONING, BY SMALL ROOMS WITHOUT VENTILATION, OR WHERE NO AIR TRANSFERS GRILLS ARE FITTED. MECHANICAL DOOR CLOSERS ARE DESIGNED TO CLOSE THE STATED AND TESTED SPECIFICATION OF DOOR WEIGHT AND DOORSETS/DOOR ASSEMBLIES WHEN DOORS ARE FITTED WITH CORRECT GAPS AND NOT BINDING ON SEALS. IF YOU ENCOUNTER PROBLEMS WITH DOORS NOT CLOSING PLEASE WATCH OUR "6 WAYS TO TROUBLESHOOT A DOOR CLOSER" VIDEO ONLINE. WHERE DOORS ARE NOT CLOSING DUE TO AIR PRESSURES THEN PROFESSIONAL ADVICE FROM AN AUTHORISED INSTALLER IS RECOMMENDED TO FIT TESTED AND THIRD PARTY CERTIFIED AIR TRANSFER GRILLS AND/OR AUTOMATIC DOOR OPERATORS.

FURTHER WARRANTY INFORMATION: <https://www.rutlanduk.co.uk/rutland-warranty>

THE PINION BOLT MUST BE TIGHTENED TO 12NM
FIRE DOORS MUST BE FITTED WITH INTUMESCENT GASKETS

Fire Doors

Use in conjunction with the IP.115 Intumescent kit + Fitting Instruction

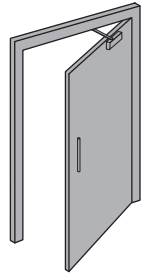

Concealed Closer - ITS.11205 Fitting Instruction

TEL: +44 (0) 1246 261 491 | www.rutlanduk.co.uk

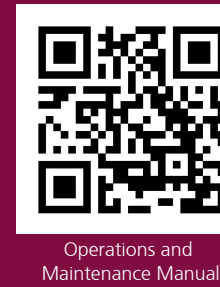

BS EN 1154

4 8 2 1 1 3

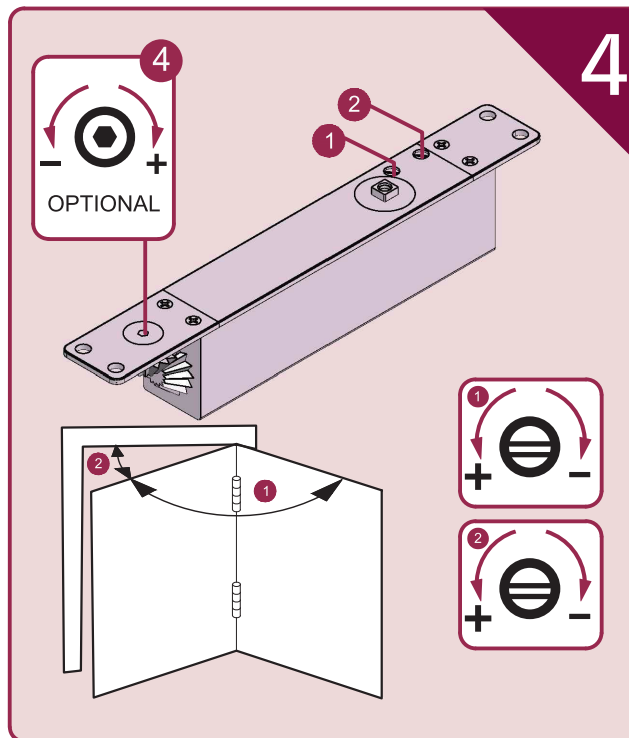
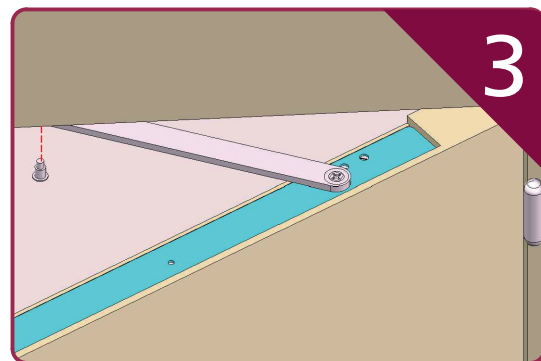
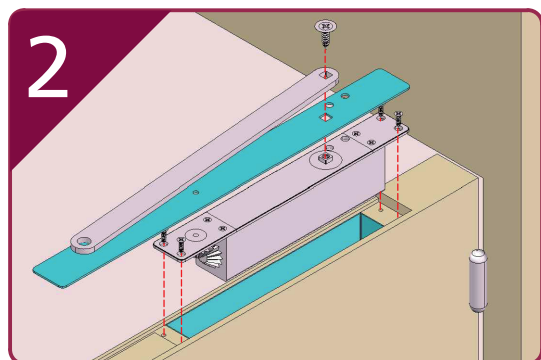
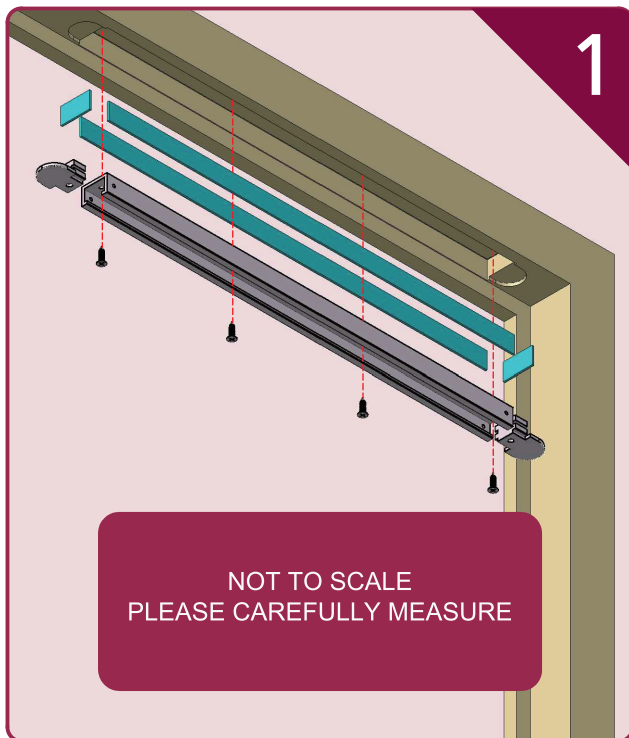
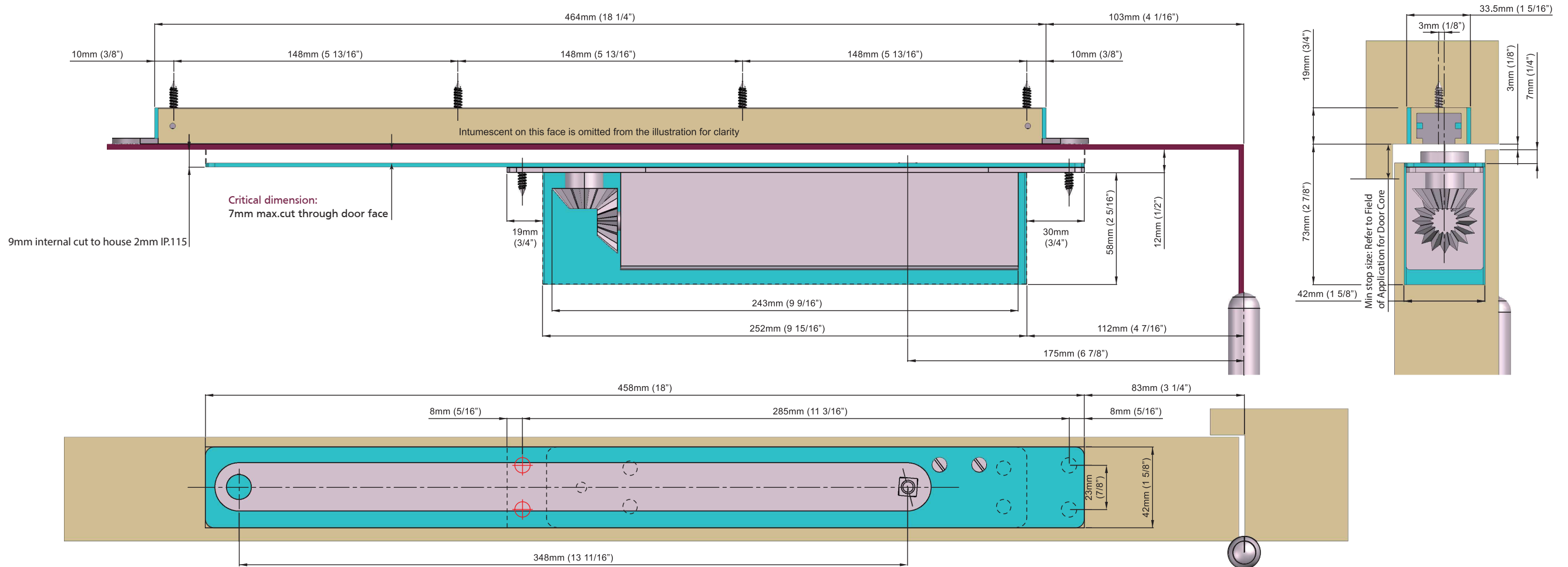

2-5 Door Closer adjustments

No. of turns	Size	Max. door width	Max. opening angle	Max weight
-3	2	850mm	110°	45
*0	3	950mm	110°	60
+3	4	1100mm	110°	80
+5	5	1250mm	110°	110

* FACTORY PRE-SET CE in size EN3-5only

IMPORTANT NOTES:
FOR UNINSULATED STEEL DOORS IP.95M MUST BE USED.
THE PINION BOLT MUST BE TIGHTENED TO 12Nm.

A MECHANICAL DOOR CLOSER IS NOT DESIGNED TO OVERCOME POOR FITTING, EXCESSIVE AIR PRESSURES OR BINDING SMOKE AND WEATHER SEALS. EXCESSIVE AIR PRESSURES CAN BE CREATED BY THROUGH DRAFT, BY AIR CONDITIONING, BY SMALL ROOMS WITHOUT VENTILATION, OR WHERE NO AIR TRANSFERS GRILLS ARE FITTED. MECHANICAL DOOR CLOSERS ARE DESIGNED TO CLOSE THE STATED AND TESTED SPECIFICATION OF DOOR WEIGHT AND DOORSETS/DOOR ASSEMBLIES WHEN DOORS ARE FITTED WITH CORRECT GAPS AND NOT BINDING ON SEALS. IF YOU ENCOUNTER PROBLEMS WITH DOORS NOT CLOSING PLEASE WATCH OUR "6 WAYS TO TROUBLESHOOT A DOOR CLOSER" VIDEO ONLINE. WHERE DOORS ARE NOT CLOSING DUE TO AIR PRESSURES THEN PROFESSIONAL ADVICE FROM AN AUTHORISED INSTALLER IS RECOMMENDED TO FIT TESTED AND THIRD PARTY CERTIFIED AIR TRANSFER GRILLS AND/OR AUTOMATIC DOOR OPERATORS.

FURTHER WARRANTY INFORMATION: <https://www.rutlanduk.co.uk/rutland-warranty>

THE PINION BOLT MUST BE TIGHTENED TO 12NM
FIRE DOORS MUST BE FITTED WITH INTUMESCENT GASKETS