

FIRE & SECURITY DOOR HARDWARE

Handles

Return to Door Lever Handle

- Complies with BS8300 (formally known as DDA)
- Bolt through fixings included
- Grade 201 Stainless Steel
- Sprung Rose
- Use on door width 35-54mm



Guarantee

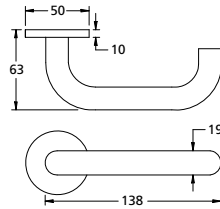

T-Bar Lever Handle

- Bolt through fixings included
- Grade 201 Stainless Steel
- Sprung Rose
- Use on door width 35-54mm



Guarantee

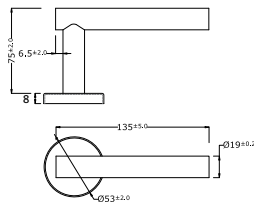

Mitred Lever Handle

- Bolt through fixings included
- Grade 201 Stainless Steel
- Sprung Rose
- Use on door width 35-54mm



Guarantee

