

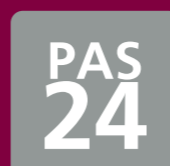

TS008 Letterplate

Fitting Instruction

TEL: +44 (0) 1246 261 491 | www.rutlanduk.co.uk



PRINT TO A3 PAPER SIZE IN 1:1 SCALE

COPYRIGHT 2024 ©

Last revision: APR 2024

To fit the letterplate, you will require the following tools:

- Adhesive tape
- Tape Measure
- Jigsaw
- Drill
- Router
- Philip cross screw-driver

Component List:

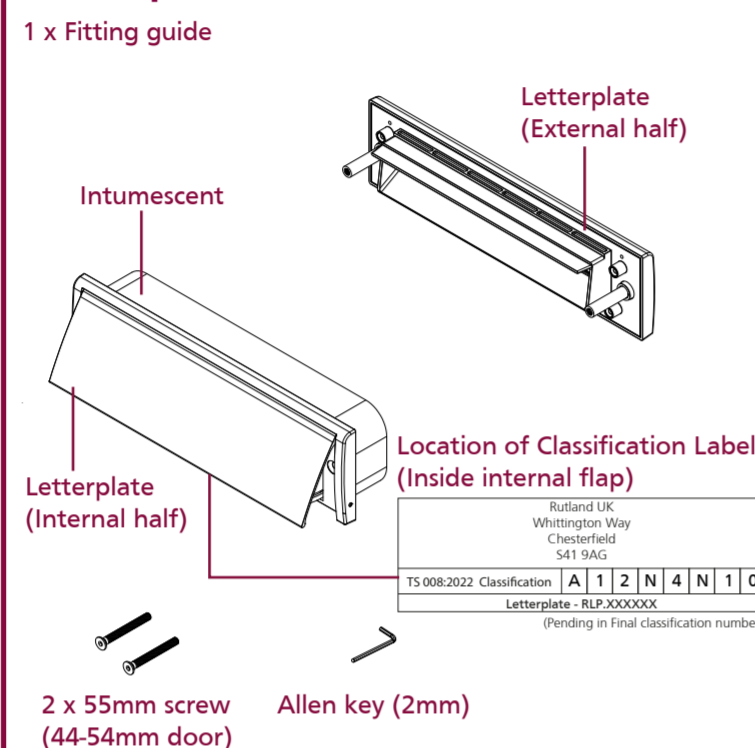

SCALE 1:1 Letterplate aperture

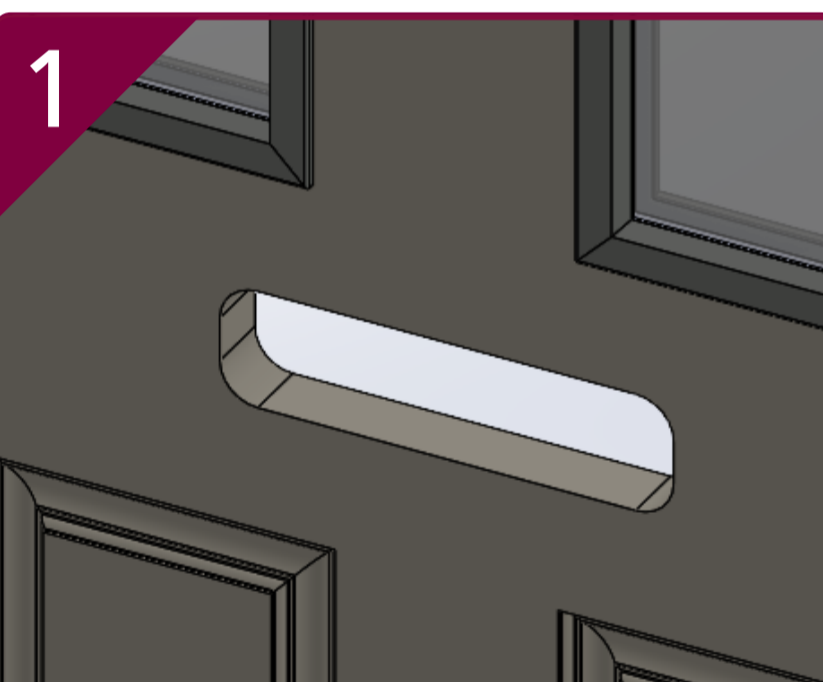
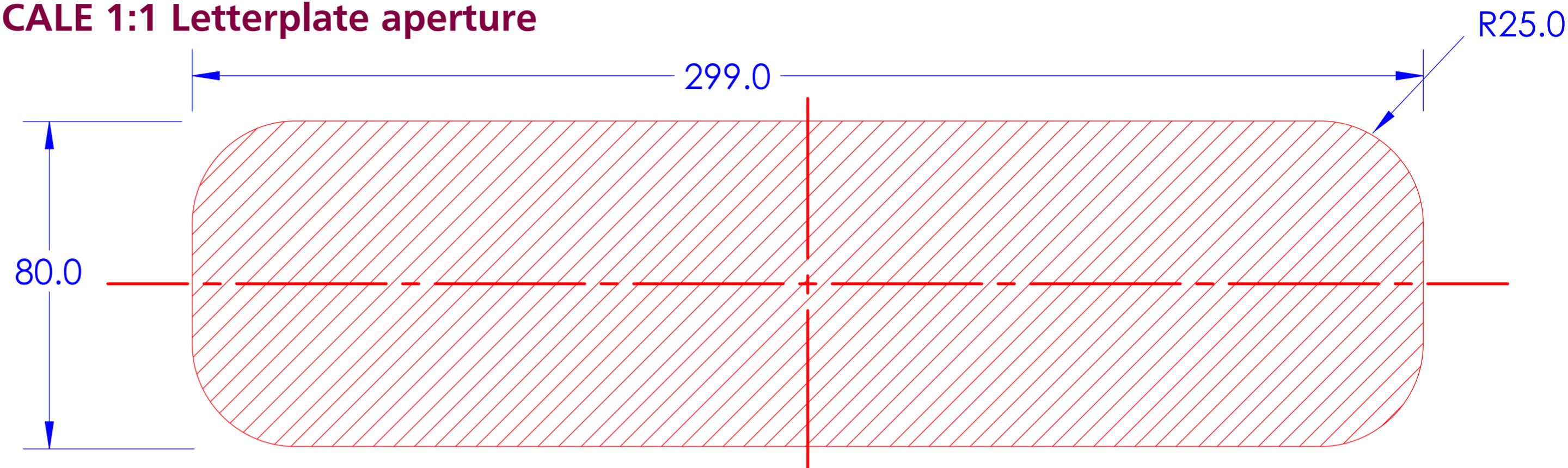

1 Mark the position for the aperture following the "Letterplate aperture" on instruction.

Place and secure the instruction sheet with adhesive tape.

Cut out aperture with jigsaw or router etc.

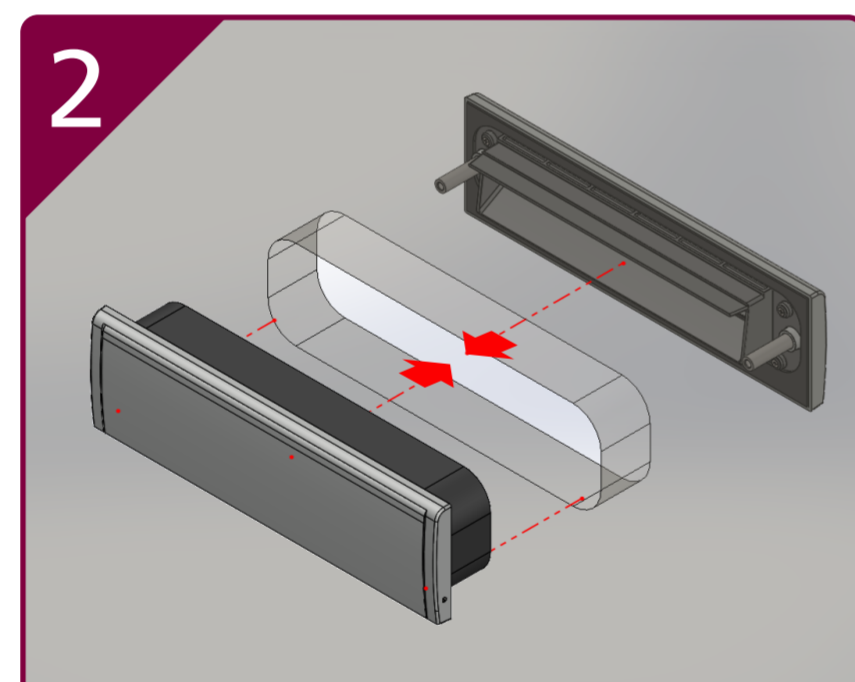

2 Insert External Assembly and Internal Assembly in the door aperture

IMPORTANT
Please ensure the intumescent sleeves surround the Internal Assembly. Plastic body of External Assembly is fully inserted to Internal side.

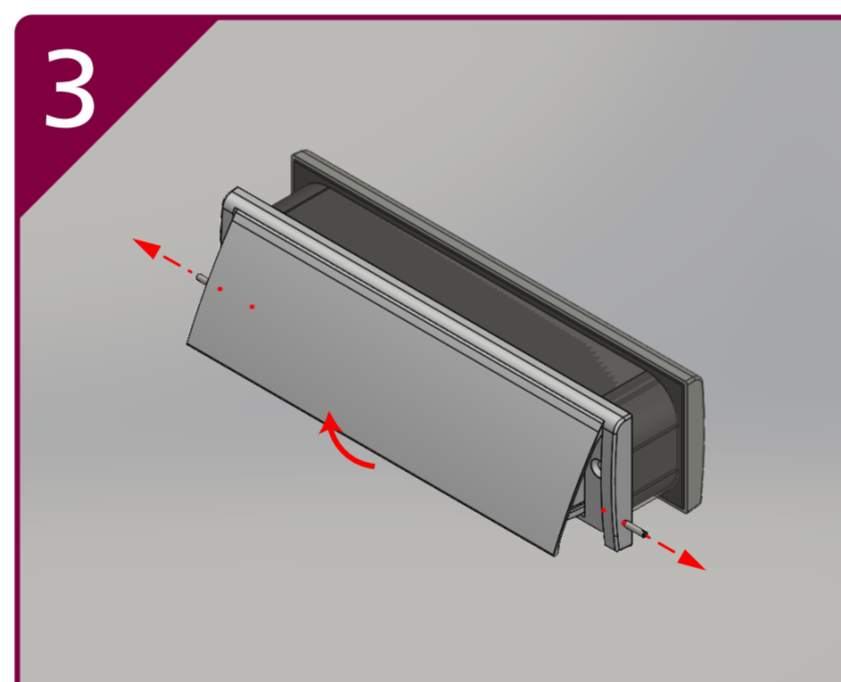

3 Release flap locking pin on 2 sides with provided allen key until Internal flap is released and able to open up to 90 degree

IMPORTANT
Side locking pins are not needed to full released.

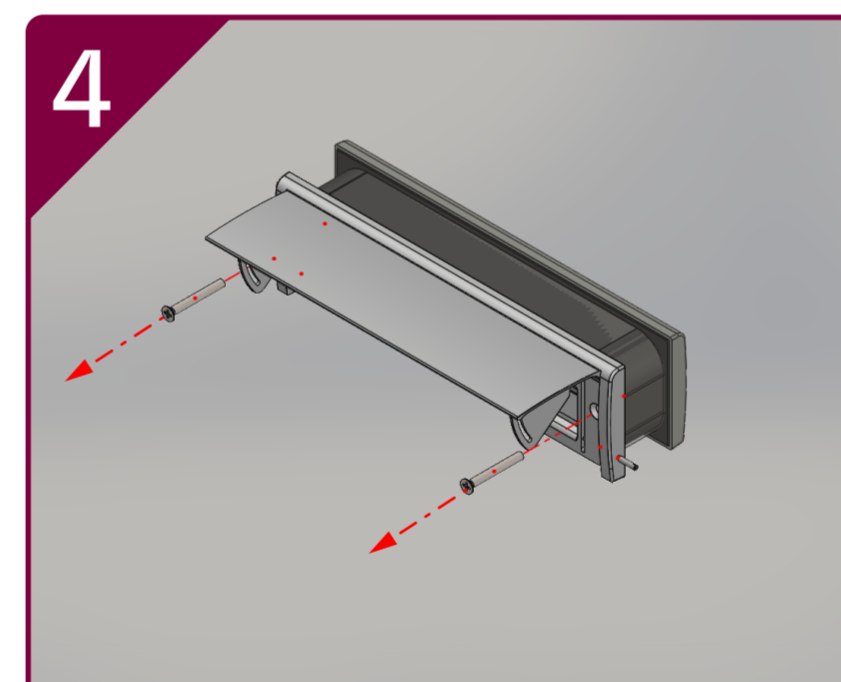

4 Open the flap up to 90 degree. Fix the internal and external letterplate together using supplied M6 fixing screws in the appropriate holes.

Optional: the rubber pad can stick on surround on M6 screw area or Internal flap underneath.

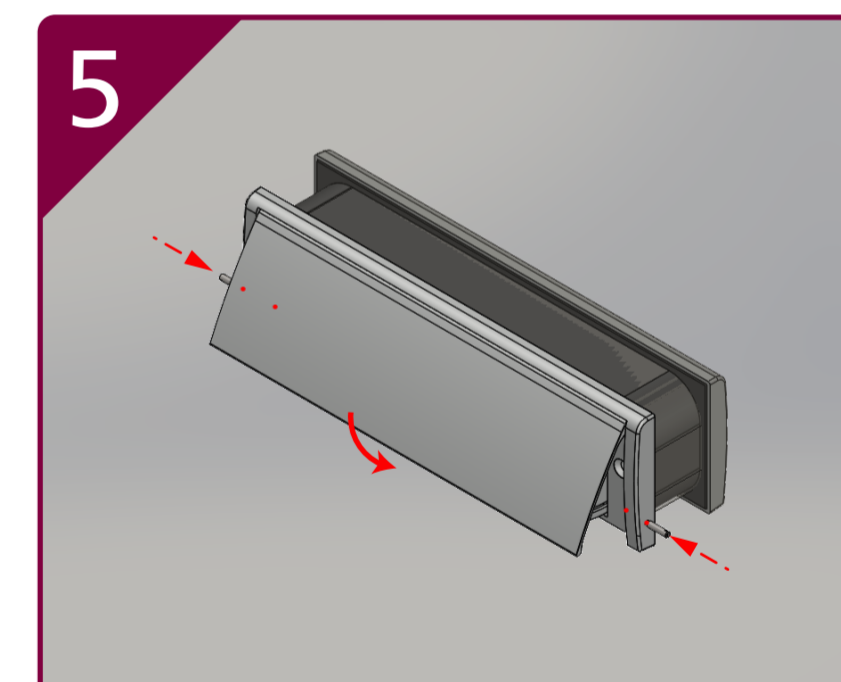

5 Release the internal flap and screw the flap locking pin inward to limit the internal flap opening by provided Allen key.

IMPORTANT
Flap locking pin **MUST** be fully screw inward and secure inside the slot of internal flap

Additional Information

Fitting Screw - has a dry coated adhesive that is activated when threaded into the hole. The screw should not be removed once fitted. They must be tightened to 12Nm

Maintenance - To ensure that your product maintains its high quality finish. Please, DO wipe regularly with soft, damp cloth to remove any finger prints. We recommend that you only use warm soapy water with a lint free cloth. Wipe dry with a soft clean cloth. DON'T use abrasive cleaners or scouring pads, bleach or solvents

Warning - Where a letter plate assembly or slide through box is fitted into a fire rated door panel, it is essential that its fire rating is the same or higher than the surround into which it is to be fitted. When considering the scope of a letterplate with fire performance for inclusion in a fire doorset, the scope shall be limited to what is proven by test, including the generic fire resisting door type/thickness used, the height/direction tested, and shall remain specific to the test standard adopted. TS008 compliant letter plates provide resistance against various methods of theft. For the optimum protection, the letterplate should be installed in line with the test methods described in TS008

Suitable for 44-54mm thickness Timber and Composite doors (Not suitable for PVC-u doors)

Technical Information
TS008:2022 Standard (Pending in Final classification number)
PAS24:2022 (pending)