

PRODUCT FILE

TS.9206

Pack includes:

- Specification/Data sheet
- Product codes
- EU CE cert
- EU CE Declaration of Performance (DoP)
- UKCA cert
- UKCA Declaration of Performance (DoP)
- Fitting instructions
- O&M Manual

SCISSOR ARM DOOR CLOSERS

TS.9206



SCISSOR ARM DOOR CLOSERS

TS.9206

TS.9206 MARINE 316 door closer has been designed for external use, ideal for heavy usage, the TS.9206 is power adjustable by spring size 3-6, has a unique slimline appearance and comes with back check and delayed action as standard.

- Suitable for use on doors up to 1400mm wide
- Standard finishes - Corrosion resistance - Grade 3: High Corrosion resistance
- MARINE 316 - Grade 5: Exceptionally high corrosion resistance
- 35 Year Guarantee
- Available in 4 different finishes for next day delivery



3rd Party Certification



Opening Angle 180°



Two-Stage Speed Regulation



Guarantee

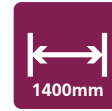

Max Door Width



Max Door Weight



Product Features	TS.9206
Delayed Action	✓
Back Check	✓
Opening Angle	180°
Fig.1 Pull Side Door Width	415-1400mm
Fig.66 Push Side Door Width	490-1250mm
Fig.1 BS8300 Min Door Width	835mm
Fig.66 BS8300 Min Door Width	728mm
Max Door Weight	<120kg
Power Adjustment	By Spring
Hold Open (not for fire doors)	◦
Dimensions (including cover)	W307 x H77 x D47mm
Certification Compliance	
Certifire	-
UKCA	✓
CE	✓
BS EN 1154	✓
BS EN 1634	✓
BS EN 1670	Grade 5
UL10C	-
UL228	-
ANSI BHMA	-
IFCC	✓
EPD 3.09E+01 kg CO ₂ eq	✓

Key: ✓ Yes - No ◦ Option

Finishes

See page 96 for more detail



SE Silver



SNP Satin Nickel



PNP Polished Nickel



M Marine 316

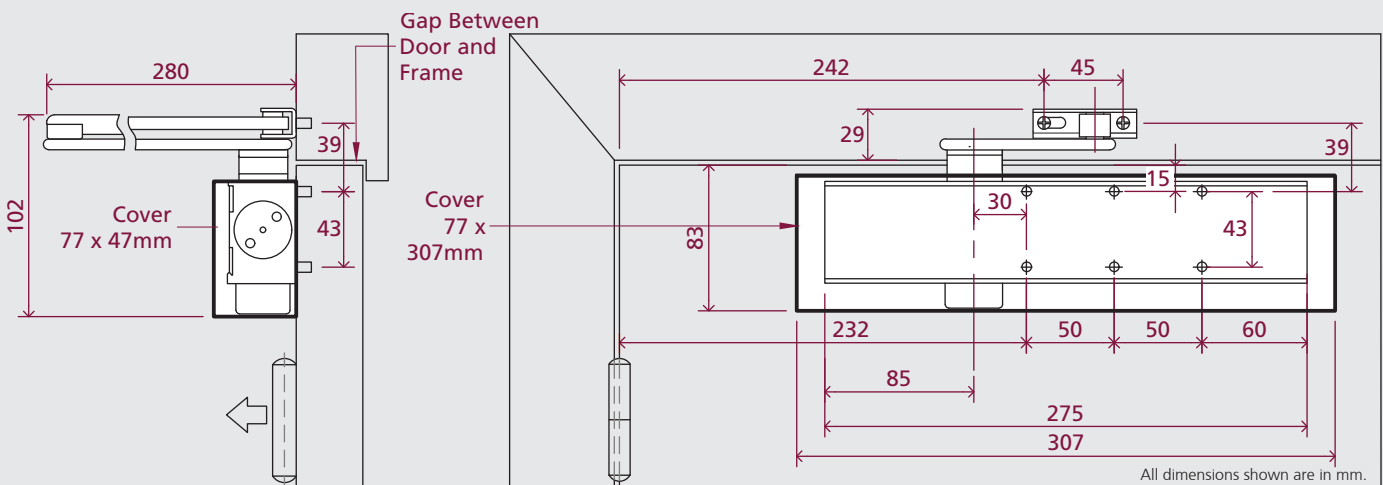

For fitting instructions see website

Description	EN Size	Finish	Re-order Code	Product Code	Box Qty
TS.9206					
WITH DELAYED ACTION AND BACK CHECK					
 <p>TS.9206 Slimline architectural door closer standard unit with back check, delayed action, flat type armset, trimplate body, cap and PA bracket.</p>	2-6	Silver	11797	TS.9206DABC.FB.SE	6
	2-6	Silver	11806	TS.9206DABC.SRFB3.SESE	6
 <p>TS.9206 Slimline architectural door closer combined unit with back check, delayed action, flat bar armset, semi-radius cover and PA bracket.</p>	2-6	Satin Nickel	11807	TS.9206DABC.SRFB3.SNPSNP	6
	2-6	Polished Nickel	11800	TS.9206DABC.SRFB3.PNPPNP	6
	2-6	Polished Brass	11802	TS.9206DABC.SRFB3.PVDPVD	6
	2-6	Satin Stainless Steel	11809	TS.9206DABC.SRFB3.SSSSSS	6
	2-6	Polished Stainless	11801	TS.9206DABC.SRFB3.PSSPSS	6
	2-6	Black	11931	TS.9206DABC.SRFB3.RAL9011BK	6
	2-6	Marine 316	12116	TS.9206DABC.SRFB3.MARS316	6
	2-6	Colour Coated	11604	TS.9206DABC.SRFB3.RAL*RAL*	6
 <p>TS.9206 Mechanism only including delayed action and back check (Infinitely variable power)</p>	2-6	Silver	11799	TS.9206DABC.FB3.SE	10
		Silver	11326	SR.96.SE	25
		Satin Nickel	11327	SR.96.SNP	25
		Polished Nickel	11321	SR.96.PNP	25
		Polished Brass	11323	SR.96.PVD	25
		Satin Stainless Steel	11328	SR.96.SSS	25
		Polished Stainless	11322	SR.96.PSS	25
		Black	12095	SR.96.RAL9011	25
		Marine 316	12115	SR.96.316S	25
 <p>TS.9206 Series semi radius cover</p>	-	Polished Nickel	11054	DP.96.SE	10
		Satin Nickel	11055	DP.96.SNP	10
		Polished Nickel	11052	DP.96.PNP	10
		Polished Brass	11053	DP.96.PVD	10
 <p>TS.9206 Drop plate (Includes fixing kit)</p>	-	Polished Nickel	11052	DP.96.PNP	10
	Polished Brass	11053	DP.96.PVD	10	
TS.9000 Series fixings pack	-	Silver	11132	FIX.90.SE	100
Mounting plate	-	Silver	12033	MP.96.SE	50
Trim plate	-	Silver	12122	TP.96.SE	50
Intumescent Kit for uninsulated steel doors	-	-	12406	IP.96M	100

CERTIFICAT DE CONSTANCE DES PERFORMANCES
CERTIFICATE OF CONSTANCY OF PERFORMANCE

N° 1812-CPR-1890

Conformément au Règlement 305/2011/EU du Parlement européen et du Conseil du 9 mars 2011 (Règlement Produits de Construction – RPC), il a été établi que le produit de construction :

In compliance with Regulation 305/2011/EU of the European Parliament and of the Council of 9 March 2011 (the Construction Products Regulation or CPR), it was established that the construction product:

Produit
Product

Dispositif de fermeture de porte avec amortissement
Controlled door closing device

Référence du produit
Reference of the product

Rutland TS.9206

mis sur le marché par ou pour
placed on the market by or for

Rutland UK
Whittington Way,
Chesterfield, S41 9AG UK

et produit dans l'usine de fabrication de
and produced in the manufacturing plant located in

E/010

est soumis par le fabricant à un contrôle de production en usine, et que EFFECTIS France, organisme de certification notifié, a réalisé les essais/calculs de type initiaux relatifs aux caractéristiques concernées du produit, l'inspection initiale de l'usine et du contrôle de la production en usine, et réalise la surveillance continue, l'évaluation et l'acceptation du contrôle de la production en usine.

is submitted by the manufacturer to a factory production control, and that the notified certification body EFFECTIS France, has performed the initial type-testing for the relevant characteristics of the product, the initial inspection of the factory and of the factory production control and performs the continuous surveillance, assessment and approval of factory production control.

Ce certificat atteste que toutes les dispositions concernant l'évaluation et la vérification de la constance des performances et les performances décrites dans l'annexe ZA de la norme de référence **EN 1154 : 1996 +A1 : 2002** pour le système 1 sont appliquées, et que le ou les produits satisfont toutes les exigences prescrites.

*This certificate attests that all provisions concerning the assessment and verification of constancy of performance and the performance, described in Annex ZA of the standard **EN 1154 : 1996 +A1 : 2002** under system 1 are applied, and that the product(s) fulfill(s) all the prescribed requirements set out above.*

Ce certificat, délivré pour la première fois le **1^{er} avril 2021**, demeure valide tant que les exigences relatives aux méthodes d'essai et au contrôle de production en usine incluses dans la norme harmonisée et utilisées pour évaluer les caractéristiques déclarées restent inchangées, et que le produit et les conditions de fabrication dans l'usine ne sont pas modifiés de manière significative.

*This certificate, first issued on **April 1st, 2021** remains valid as long as the test methods and/or factory production control requirements included in the harmonised standard, used to assess the performance of the declared characteristics, do not change, and the product and the manufacturing conditions in the plant are not modified significantly.*

Ce certificat permet au fabricant, ses mandataires ou ses distributeurs, établis dans l'Espace Economique Européen, d'apposer le marquage CE.

This certificate allows the manufacturer, its mandatories or its distributors, stated in the European Economic Area, to affix the CE marking.

Certificat établi à Saint-Aubin le / *Certificate established at Saint-Aubin on* : **01/02/2023.**

Par délégation du Directeur technique Certification / *By delegation of the technical Certification director,*

Yannick LE TALLEC
Directrice Certification / *Certification director*



Organisme notifié
Notified body
n° 1812

ANNEXE AU CERTIFICAT DE CONSTANCE DES PERFORMANCES N° 1812-CPR-1890
A LA NORME EN 1154 : 1996 +A1 : 2002
ANNEX TO THE CERTIFICATE OF CONSTANCY OF PERFORMANCE
TO THE STANDARD EN 1154 : 1996 +A1 : 2002

Produit <i>Product</i>	Dispositif de fermeture de porte avec amortissement <i>Controlled door closing device</i>
Référence du produit <i>Reference of the product</i>	Rutland TS.9206
Certificat délivré à <i>Certificate delivered to</i>	Rutland UK Whittington Way, Chesterfield, S41 9AG UK

Description du champ couvert par le certificat / Description of the field covered by the certificate:

Ferme porte avec amortissement - dispositif de fermeture contrôlé à action unique à force ajustable
Adjustable strength single action controlled door closing device

Installation du produit / <i>Product installation</i>	Classification EN 1154 / <i>Classification EN 1154</i>					
Position standard / <i>Standard position</i>	4	8	3 à/to 6	1	1	3

Installation du produit / <i>Product installation</i>	Classification EN 1154 / <i>Classification EN 1154</i>					
Position parallèle / <i>Parallel position</i>	3	8	3 à/to 5	1	1	3

Certificat établi à Saint-Aubin le / *Certificate established at Saint-Aubin on* : **01/02/2023.**

Par délégation du Directeur technique Certification / *By delegation of the technical Certification director,*

Yannick LE TALLEC
 Directrice Certification / *Certification director*



DECLARATION OF PERFORMANCE



DoP-TS.9206-1/66-CE

(TS.9206 Fig 1 Pull Side & Fig 66 Push Side)

- Unique identification code of the product / type:-
TS.9206 DA BC 3-5 variable power Surface Fixed Door Closer with Fig 66 Parallel Arm Fixing Position, with optional back check, delayed action and adjustable latch action, 120 degree maximum opening angle.
TS. 9206 DA BC 3-5 variable power Surface Fixed Door Closer with Fig 1 Standard Fixing fitted pull side with optional back check, delayed action and adjustable latch action, 180 degree maximum opening angle.
- **Re-order Code allowing identification of the construction product as required under Article 11(4) of CPR:**
 11797, 11806, 11807, 11800, 11802, 11809, 11801, 11931, 12116, 11604, 11799
- Intended use:- For use on fire/smoke compartmentation doors, when fitted in accordance with the supplied fitting instructions and maintained to the manufacturers O&M Manual.
- Manufacturer:- Rutland Door Controls Europe Limited, Unit 5B, Fingal Bay Business Park, Balbriggan, Dublin, Ireland
- System/s assessment and verification of constancy of performance (AVCP):- System 1
- Harmonised Standard:- EN 1154:1996 + A1:2002
- Notified Body:- Efectis EU notified body no. 1812
- Certification No.:- 1812-CPR-1890 dated 08-01-2024
- Declared Performance:-

Conditioning: Parallel Arm Fixing Position (Fig 66) power size 3-5, with optional back check, delayed action and adjustable latch action, 120 degree maximum opening angle

Essential Characteristics	Performance	Harmonised Technical Specification
<i>Self-closing (5.2.1 General)</i>		EN 1154:1996 + A1:2002
5.2.2 Durability	500,000 test cycles	
5.2.3 Closing moment	Power size 3 - 5	
5.2.4 Opening moment	Power size 3 - 5	
5.2.5 Efficiency	Pass	
5.2.6 Closing time	Pass	
5.2.7 Angles of operation	Grade 3 for closing doors from 105 degrees	
5.2.8 Overload performance	Pass	
5.2.9 Temperature dependence	-15°C to +40°C	
5.2.10 Fluid leakage	Pass	
5.2.11 Damage	Pass	
5.2.12 Latch control	Pass	
5.2.13 Back check	Pass	
5.2.15 Adjustable closing force	Pass	

DECLARATION OF PERFORMANCE



<i>Durability of Self Closing</i>		EN 1154:1996 + A1:2002
5.2.2 Durability	500,000 test cycles – Grade 8	
5.2.17 Corrosion resistance	High corrosion resistance - Grade 3 (96 hours)	
Dangerous Substances	Pass: the materials in the door closer do not contain or release any dangerous substances in excess of the maximum levels specified in existing European material standards or any national regulations (1)	

The performance of the product identified above is in conformity with the set of declared performance/s.

This declaration of performance is issued, in accordance with Regulation (EU) No 305/2011, under the sole responsibility of the manufacturer identified above.

Signed for and on behalf of the manufacturer by:

A handwritten signature in black ink, appearing to read 'Kevin O'Reilly', written over a horizontal line.

Kevin O'Reilly
Technical Director

Dated 18-04-2024

DECLARATION OF PERFORMANCE



DoP-TS.9206-1-CE

(TS.9206 Fig 1)

- Unique identification code of the product / type:-
TS.9206 DA BC 3-6 variable power Surface Fixed Door Closer with Fig 1 Standard Fixing Position, with optional back check, delayed action and adjustable latch action, 180 degree maximum opening angle.
- **Re-order Code allowing identification of the construction product as required under Article 11(4) of CPR:**
11797, 11806, 11807, 11800, 11802, 11809, 11801, 11931, 12116, 11604, 11799
- Intended use:- For use on fire/smoke compartmentation doors, when fitted in accordance with the supplied fitting instructions and maintained to the manufacturers O&M Manual.
- Manufacturer:- Rutland Door Controls Europe Limited, Unit 5B, Fingal Bay Business Park, Balbriggan, Dublin, Ireland
- System or systems assessment and verification of constancy of performance (AVCP):- System 1
- Harmonised Standard:- EN 1154:1996 + A1:2002
- Notified Body:- Efectis EU notified body no. 1812
- Certification No.:- 1812-CPR-1890 dated 08-01-2024
- Declared Performance:-

Conditioning: Standard Position (Fig 1) power size 2-5, with optional back check, delayed action and adjustable latch action, 180 degree maximum opening angle

Essential Characteristics	Performance	Harmonised Technical Specification
<i>Self-closing (5.2.1 General)</i>		EN 1154:1996 + A1:2002
5.2.2 Durability	500,000 test cycles	
5.2.3 Closing moment	Power size 3 - 6	
5.2.4 Opening moment	Power size 3 - 6	
5.2.5 Efficiency	Pass	
5.2.6 Closing time	Pass	
5.2.7 Angles of operation	Grade 4 for closing doors from 180 degrees	
5.2.8 Overload performance	Pass	
5.2.9 Temperature dependence	-15°C to +40°C	
5.2.10 Fluid leakage	Pass	
5.2.11 Damage	Pass	
5.2.12 Latch control	Pass	
5.2.13 Back check	Pass	
5.2.15 Adjustable closing force	Pass	

DECLARATION OF PERFORMANCE



<i>Durability of Self Closing</i>		EN 1154:1996 + A1:2002
5.2.2 Durability	500,000 test cycles – Grade 8	
5.2.17 Corrosion resistance	High corrosion resistance - Grade 3 (96 hours)	
Dangerous Substances	Pass: the materials in the door closer do not contain or release any dangerous substances in excess of the maximum levels specified in existing European material standards or any national regulations (1)	

The performance of the product identified above is in conformity with the set of declared performance/s.

This declaration of performance is issued, in accordance with Regulation (EU) No 305/2011, under the sole responsibility of the manufacturer identified above.

Signed for and on behalf of the manufacturer by:

A handwritten signature in dark ink, appearing to read 'Kevin O'Reilly', written in a cursive style.

Kevin O'Reilly
Technical Director

Dated 18-04-2024



CERTIFICATE OF CONSTANCY OF PERFORMANCE

1720-CPR-0184

In compliance with Statutory Instruments 2019 No.465 of the United Kingdom Houses of Parliament 5th March 2019 (The Construction Products (Amendment etc.) (EU Exit) Regulations 2019), this certificate applies to the construction product:

Rutland TS.9206 DABC Overhead Door Closer – With adjustable delayed action or back-check

An overhead surface mounted closer for use on single action, single or double leaf fire resisting and smoke control doors.

product classification	4	8	2 6	1	1	3
------------------------	---	---	--------	---	---	---

Particular conditions applicable: **Variable power size 2 to 6 in Standard and Transom fixing position with adjustable back check.**

product classification	4	8	2 5	1	1	3
------------------------	---	---	--------	---	---	---

Particular conditions applicable: **Variable power size 2 to 5 in Parallel arm fixing position.**

produced by

Rutland UK

Whittington Way, Chesterfield, S41 9AG

and produced in the manufacturing plant(s)

Factory Code: B - O

This certificate attests that all provisions concerning the assessment and verification of constancy of performance and the performances described in Annex ZA of the standard(s)

BS EN 1154:1997 + A1:2002

Under system 1 are applied and that the product fulfils all the prescribed requirements set out above.

This certificate was first issued on 1st January 2021 and will remain valid as long as neither the designated standard, the construction product, the AVCP methods nor the manufacturing conditions in the plant are not modified significantly unless suspended or withdrawn by the approved product certification body.



Princes Risborough, UK

Director of Certification

IFC Certification Ltd
UK Approved Body No. 1720

20 Park Street, Princes Risborough, Buckinghamshire, HP27 9AH, UK
Tel: +44(0) 1844 275500, Fax: +44(0) 1844 274002, E-mail: info@ifccertification.com
Registered No: 4777898 England
©IFC Certification Ltd 2021

DECLARATION OF PERFORMANCE



DoP-TS.9206-1/66-UKCA

(TS.9206 Fig 1 Pull Side & Fig 66 Push Side)

- Unique identification code of the product / type:-
TS.9206 DA BC 3-5 variable power Surface Fixed Door Closer with Fig 66 Parallel Arm Fixing Position, with optional back check, delayed action and adjustable latch action, 120 degree maximum opening angle.
TS. 9206 DA BC 3-5 variable power Surface Fixed Door Closer with Fig 1 Standard Fixing fitted pull side with optional back check, delayed action and adjustable latch action, 180 degree maximum opening angle.
- **Re-order Code allowing identification of the construction product as required under Article 11(4) of CPR:**
 11797, 11806, 11807, 11800, 11802, 11809, 11801, 11931, 12116, 11604, 11799
- Intended use:- For use on fire/smoke compartmentation doors, when fitted in accordance with the supplied fitting instructions and maintained to the manufacturers O&M Manual.
- Manufacturer:- Rutland UK, Unit 4, Holmewood Business Park, Chesterfield Road, Chesterfield, S42 5US, UK
- System or systems of assessment and verification of constancy of performance of the construction product as set out in CPR, Annex V :- System 1
- Harmonised Standard:- BS EN 1154:1997 + A1:2002
- Notified Body:- IFCC UK Conformity Assessment body No. 1720
- Certification No.:- 1720-CPR-0184
- Declared Performance:-

Conditioning: Parallel Arm Fixing Position (Fig 66) power size 3-5, with optional back check, delayed action and adjustable latch action, 120 degree maximum opening angle

Essential Characteristics	Performance	Harmonised Technical Specification
<i>Self-closing (5.2.1 General)</i>		BS EN 1154:1997 + A1:2002
5.2.2 Durability	500,000 test cycles	
5.2.3 Closing moment	Power size 3 - 5	
5.2.4 Opening moment	Power size 3 - 5	
5.2.5 Efficiency	Pass	
5.2.6 Closing time	Pass	
5.2.7 Angles of operation	Grade 3 for closing doors from 105 degrees	
5.2.8 Overload performance	Pass	
5.2.9 Temperature dependence	-15°C to +40°C	
5.2.10 Fluid leakage	Pass	
5.2.11 Damage	Pass	
5.2.12 Latch control	Pass	
5.2.13 Back check	Pass	
5.2.15 Adjustable closing force	Pass	

DECLARATION OF PERFORMANCE



<i>Durability of Self Closing</i>		BS EN 1154:1997 + A1:2002
5.2.2 Durability	500,000 test cycles – Grade 8	
5.2.17 Corrosion resistance	High corrosion resistance - Grade 3 (96 hours)	
Dangerous Substances	Pass: the materials in the door closer do not contain or release any dangerous substances in excess of the maximum levels specified in existing European material standards or any national regulations (1)	

The performance of the product identified above is in conformity with the set of declared performance/s.

This declaration of performance is issued, in accordance with the Construction Products (Amendment etc) (EU Exit) Regulations, 2019 No. 465 & 2020 No.1359.

Signed for and on behalf of the manufacturer by:

A handwritten signature in black ink, appearing to read 'Kevin O'Reilly', written over a horizontal line.

Kevin O'Reilly
Technical Director

Dated 18-04-2024

DECLARATION OF PERFORMANCE



DoP-TS.9206-1-UKCA



(TS.9206 Fig 1)

- Unique identification code of the product / type:-
TS.9206 DA BC 3-6 variable power Surface Fixed Door Closer with Fig 1 Standard Fixing Position, with optional back check, delayed action and adjustable latch action, 180 degree maximum opening angle.
- **Re-order Code allowing identification of the construction product as required under Article 11(4) of CPR:**
11797, 11806, 11807, 11800, 11802, 11809, 11801, 11931, 12116, 11604, 11799
- Intended use:- For use on fire/smoke compartmentation doors, when fitted in accordance with the supplied fitting instructions and maintained to the manufacturers O&M Manual.
- Manufacturer:- Rutland UK, Unit 4, Holmewood Business Park, Chesterfield Road, Chesterfield, S42 5US, UK
- System or systems of assessment and verification of constancy of performance of the construction product as set out in CPR, Annex V :- System 1
- Harmonised Standard:- BS EN 1154:1997 + A1:2002
- Notified Body:- IFCC UK Conformity Assessment body No. 1720
- Certification No.:- 1720-CPR-0184
- Declared Performance:-

Conditioning: Standard Position (Fig 1) power size 2-5, with optional back check, delayed action and adjustable latch action, 180 degree maximum opening angle

Essential Characteristics	Performance	Harmonised Technical Specification
<i>Self-closing (5.2.1 General)</i>		BS EN 1154:1997 + A1:2002
5.2.2 Durability	500,000 test cycles	
5.2.3 Closing moment	Power size 3 - 6	
5.2.4 Opening moment	Power size 3 - 6	
5.2.5 Efficiency	Pass	
5.2.6 Closing time	Pass	
5.2.7 Angles of operation	Grade 4 for closing doors from 180 degrees	
5.2.8 Overload performance	Pass	
5.2.9 Temperature dependence	-15°C to +40°C	
5.2.10 Fluid leakage	Pass	
5.2.11 Damage	Pass	
5.2.12 Latch control	Pass	
5.2.13 Back check	Pass	
5.2.15 Adjustable closing force	Pass	

DECLARATION OF PERFORMANCE



<i>Durability of Self Closing</i>		BS EN 1154:1997 + A1:2002
5.2.2 Durability	500,000 test cycles – Grade 8	
5.2.17 Corrosion resistance	High corrosion resistance - Grade 3 (96 hours)	
Dangerous Substances	Pass: the materials in the door closer do not contain or release any dangerous substances in excess of the maximum levels specified in existing European material standards or any national regulations (1)	

The performance of the product identified above is in conformity with the set of declared performance/s.

This declaration of performance is issued, in accordance with the Construction Products (Amendment etc) (EU Exit) Regulations, 2019 No. 465 & 2020 No.1359.

Signed for and on behalf of the manufacturer by:

A handwritten signature in black ink, appearing to read 'Kevin O'Reilly', written over a horizontal line.

Kevin O'Reilly
Technical Director

Dated 18-04-2024



Standard Arm Fig 1 (Pull Side) TS9206



BS EN 1154

4	8	2	1	1	3
3	8	6	1	1	3

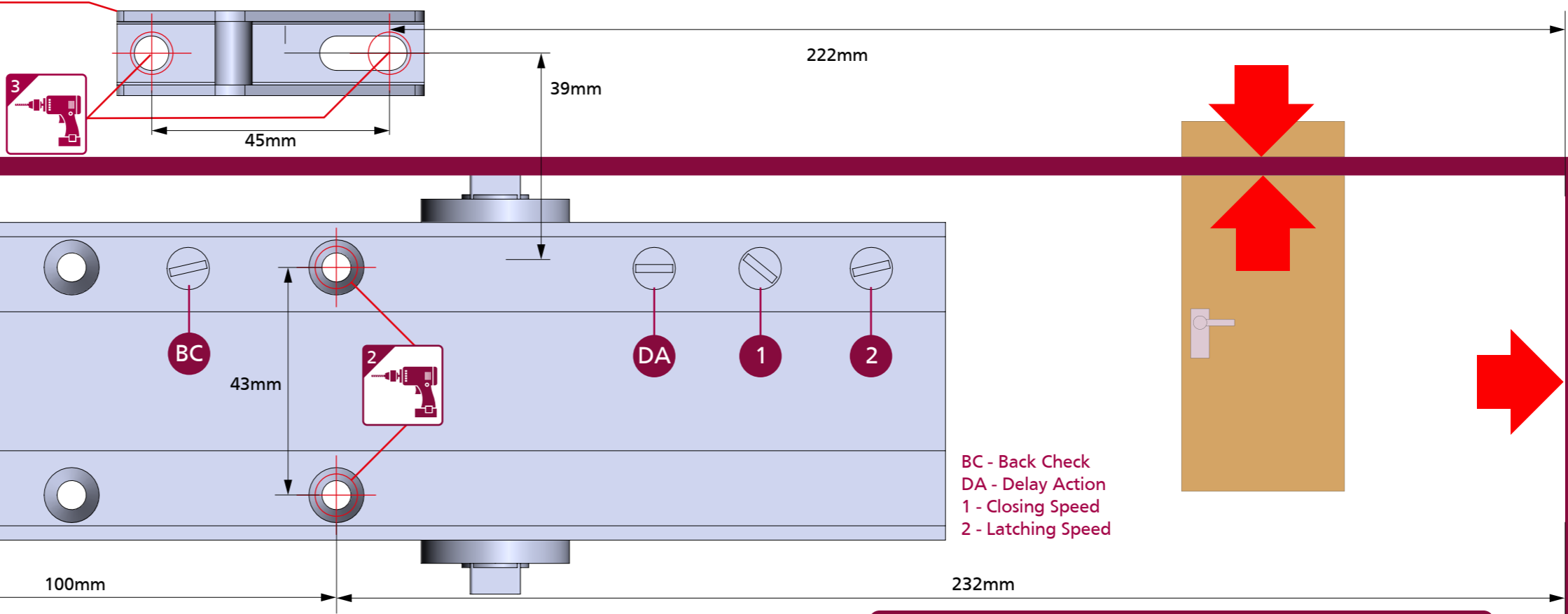
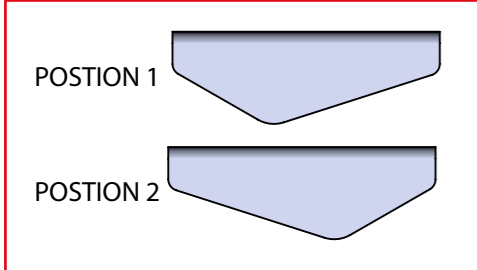

BC - Back Check
DA - Delay Action
1 - Closing Speed
2 - Latching Speed

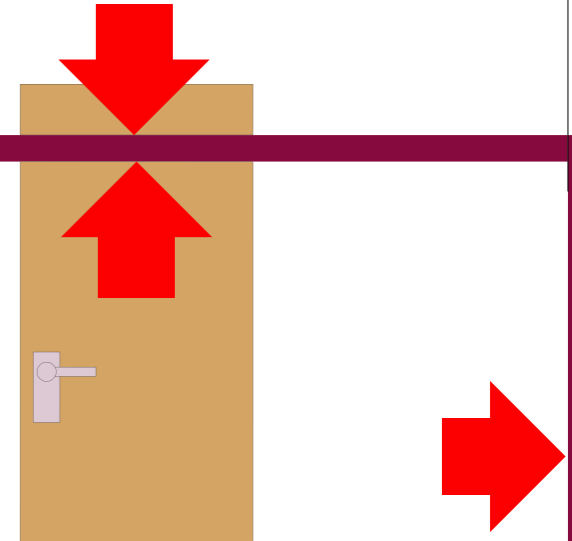

EN 2-6 Power Size

No of turns	EN Size	Shoe Position	Max door width	Open Angle	Max weight
-4	2 ^A	2	850mm	180°	45
-2	3	2	950mm	180°	60
0*	4	1	1100mm	180°	80
+3	5	1	1250mm	180°	110
+8	6	1	1400mm	110°	120

*FACTORY PRE-SET
A - EN2 NOT SUITABLE FOR FIRE DOOR

IMPORTANT NOTES:
DELAYED ACTION & BACK CHECK (DABC) VALVES ARE NOT STANDARD, THESE ARE OPTIONAL.
FOR UNINSULATED STEEL DOORS IP.95M MUST BE USED.
THE PINION BOLT MUST BE TIGHTENED TO 12Nm.

A MECHANICAL DOOR CLOSER IS NOT DESIGNED TO OVERCOME POOR FITTING, EXCESSIVE AIR PRESSURES OR BINDING SMOKE AND WEATHER SEALS. EXCESSIVE AIR PRESSURES CAN BE CREATED BY THROUGH DRAFT, BY AIR CONDITIONING, BY SMALL ROOMS WITHOUT VENTILATION, OR WHERE NO AIR TRANSFERS GRILLS ARE FITTED. MECHANICAL DOOR CLOSERS ARE DESIGNED TO CLOSE THE STATED AND TESTED SPECIFICATION OF DOOR WEIGHT AND DOORSETS/DOOR ASSEMBLIES WHEN DOORS ARE FITTED WITH CORRECT GAPS AND NOT BINDING ON SEALS. IF YOU ENCOUNTER PROBLEMS WITH DOORS NOT CLOSING PLEASE WATCH OUR "6 WAYS TO TROUBLESHOOT A DOOR CLOSER" VIDEO ONLINE. WHERE DOORS ARE NOT CLOSING DUE TO AIR PRESSURES THEN PROFESSIONAL ADVICE FROM AN AUTHORISED INSTALLER IS RECOMMENDED TO FIT TESTED AND THIRD PARTY CERTIFIED AIR TRANSFER GRILLS AND/OR AUTOMATIC DOOR OPERATORS.
NOTE: BC VALVES ARE DESIGNED TO ASSIST BACK-CHECK AND DO NOT REPLACE THE REQUIREMENT FOR CORRECTLY FITTED DOORSTOPS OR SAFETY BARRIERS.

FURTHER WARRANTY INFORMATION: <https://www.rutlanduk.co.uk/rutland-warranty>

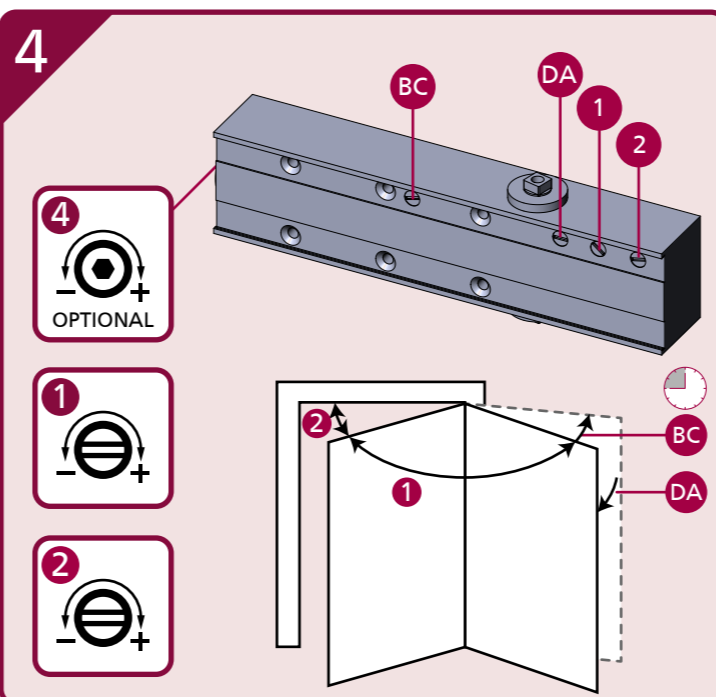
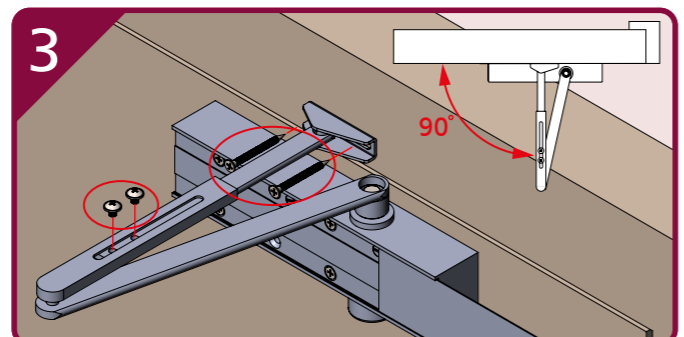
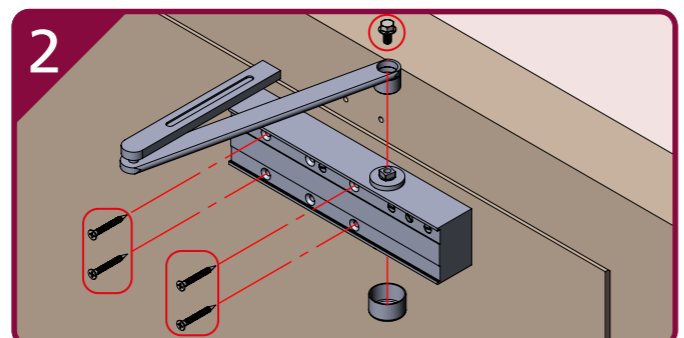
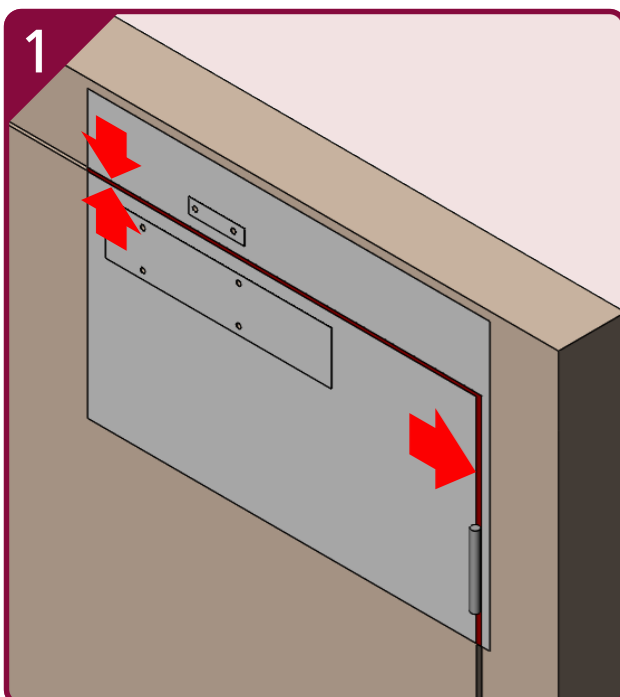



Standard Arm Fig 1 (Pull Side)

TS9206

TEL: +44 (0) 1246 261 491 | www.rutlanduk.co.uk



Operations and Maintenance Manual



35 YEARS WARRANTY



1400mm Max door width



120Kg Max door weight



BS EN 1154

4	8	2	1	1	3
3	8	6	1	1	3



1812 1720

PRINT TO A3 PAPER SIZE FOR 1:1 SCALE

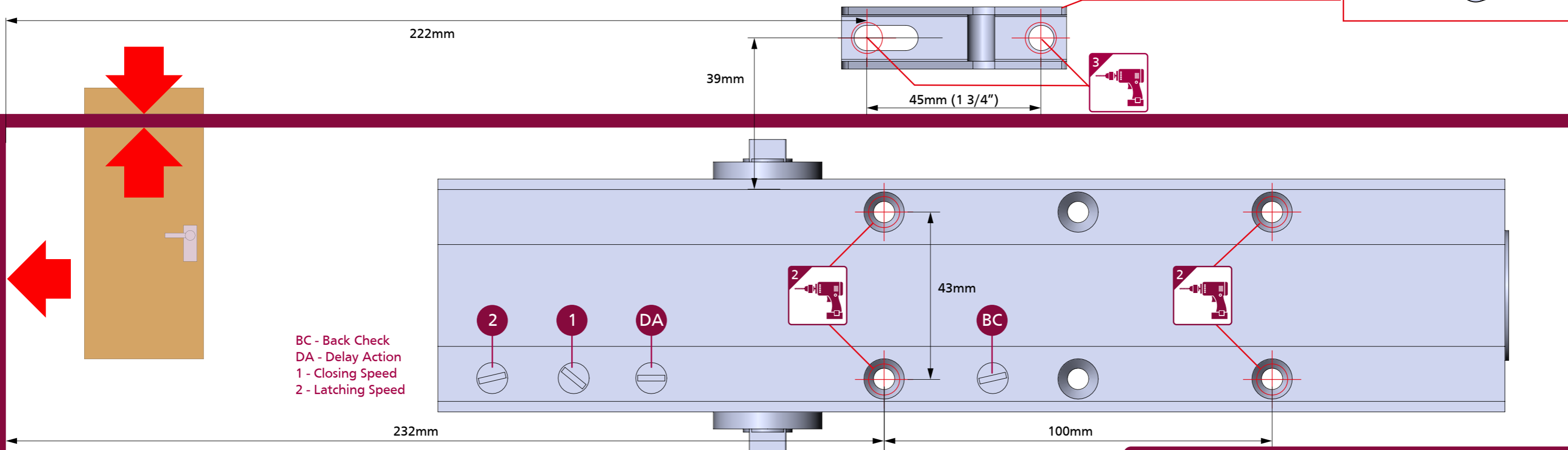
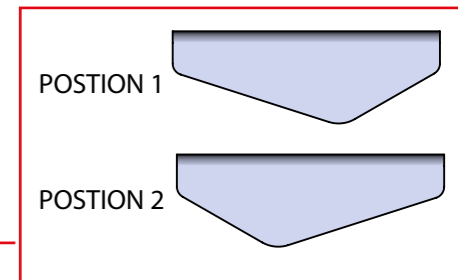

BC - Back Check
 DA - Delay Action
 1 - Closing Speed
 2 - Latching Speed

EN 2-6 Power Size

No of turns	EN Size	Shoe Position	Max door width	Open Angle	Max weight
-4	2 ^A	2	850mm	180°	45
-2	3	2	950mm	180°	60
0*	4	1	1100mm	180°	80
+3	5	1	1250mm	180°	110
+8	6	1	1400mm	110°	120

*FACTORY PRE-SET
 A - EN2 NOT SUITABLE FOR FIRE DOOR

IMPORTANT NOTES:
 DELAYED ACTION & BACK CHECK (DABC) VALVES ARE NOT STANDARD, THESE ARE OPTIONAL.
 FOR UNINSULATED STEEL DOORS IP.95M MUST BE USED.
 THE PINION BOLT MUST BE TIGHTENED TO 12Nm.

A MECHANICAL DOOR CLOSER IS NOT DESIGNED TO OVERCOME POOR FITTING, EXCESSIVE AIR PRESSURES OR BINDING SMOKE AND WEATHER SEALS. EXCESSIVE AIR PRESSURES CAN BE CREATED BY THROUGH DRAFT, BY AIR CONDITIONING, BY SMALL ROOMS WITHOUT VENTILATION, OR WHERE NO AIR TRANSFERS GRILLS ARE FITTED. MECHANICAL DOOR CLOSERS ARE DESIGNED TO CLOSE THE STATED AND TESTED SPECIFICATION OF DOOR WEIGHT AND DOORSETS/DOOR ASSEMBLIES WHEN DOORS ARE FITTED WITH CORRECT GAPS AND NOT BINDING ON SEALS. IF YOU ENCOUNTER PROBLEMS WITH DOORS NOT CLOSING PLEASE WATCH OUR "6 WAYS TO TROUBLESHOOT A DOOR CLOSER" VIDEO ONLINE. WHERE DOORS ARE NOT CLOSING DUE TO AIR PRESSURES THEN PROFESSIONAL ADVICE FROM AN AUTHORISED INSTALLER IS RECOMMENDED TO FIT TESTED AND THIRD PARTY CERTIFIED AIR TRANSFER GRILLS AND/OR AUTOMATIC DOOR OPERATORS.

NOTE: BC VALVES ARE DESIGNED TO ASSIST BACK-CHECK AND DO NOT REPLACE THE REQUIREMENT FOR CORRECTLY FITTED DOORSTOPS OR SAFETY BARRIERS.

FURTHER WARRANTY INFORMATION: <https://www.rutlanduk.co.uk/rutland-warranty>

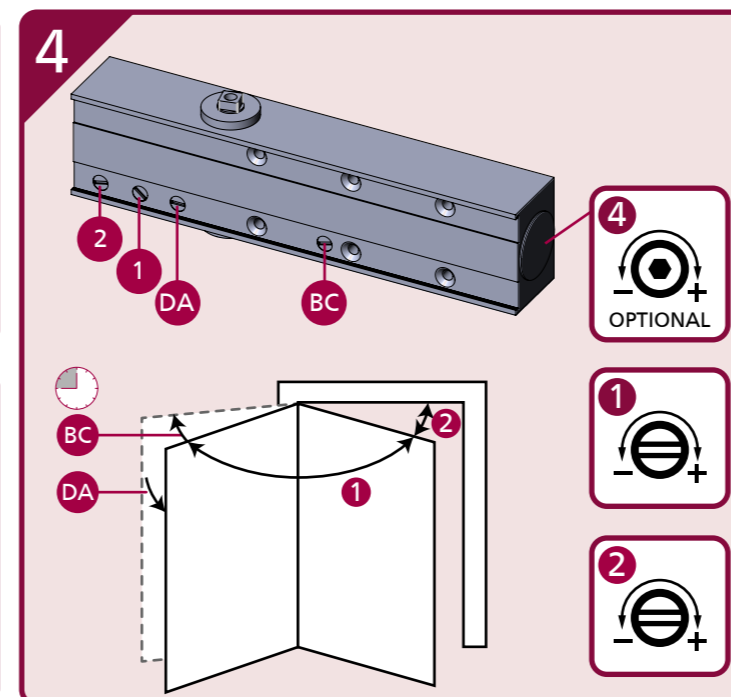
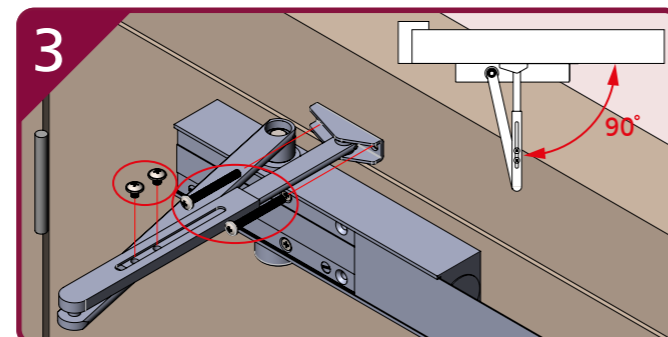
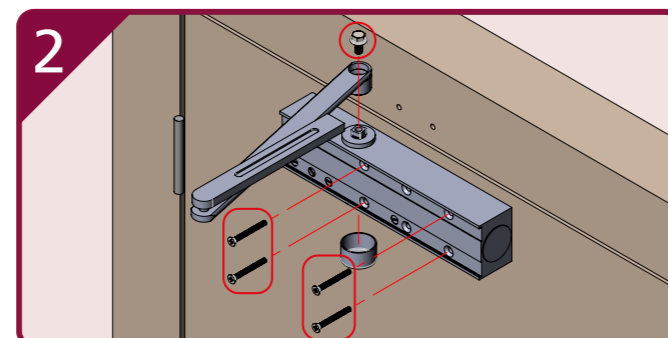
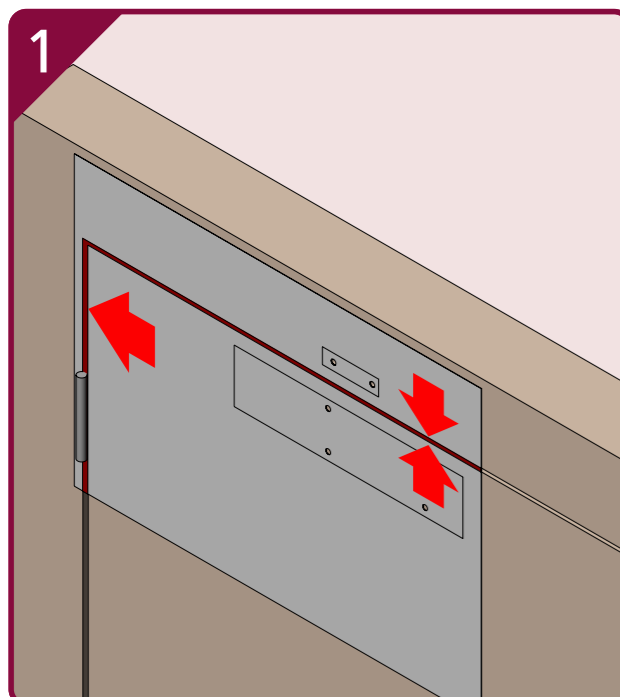



Parallel Arm Fig 6 (Push-side)

TS9206

TEEL: +44(0)12266286149911 | www.rutlanduk.co.uk



Operations and Maintenance Manual

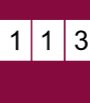

FOLD →

FOLD 2

IMPORTANT NOTES:
 DELAYED ACTION & BACK CHECK (DABC) VALVES ARE NOT STANDARD, THESE ARE OPTIONAL.
 FOR UNINSULATED STEEL DOORS IP.95M MUST BE USED.
 THE PINION BOLT MUST BE TIGHTENED TO 12Nm.

A MECHANICAL DOOR CLOSER IS NOT DESIGNED TO OVERCOME POOR FITTING, EXCESSIVE AIR PRESSURES OR BINDING SMOKE AND WEATHER SEALS. EXCESSIVE AIR PRESSURES CAN BE CREATED BY THROUGH DRAFT, BY AIR CONDITIONING, BY SMALL ROOMS WITHOUT VENTILATION, OR WHERE NO AIR TRANSFER GRILLS ARE FITTED. MECHANICAL DOOR CLOSERS ARE DESIGNED TO CLOSE THE STATED AND TESTED SPECIFICATION OF DOOR WEIGHT AND DOORSETS/DOOR ASSEMBLIES WHEN DOORS ARE FITTED WITH CORRECT GAPS AND NOT BINDING ON SEALS. IF YOU ENCOUNTER PROBLEMS WITH DOORS NOT CLOSING PLEASE WATCH OUR "6 WAYS TO TROUBLESHOOT A DOOR CLOSER" VIDEO ONLINE. WHERE DOORS ARE NOT CLOSING DUE TO AIR PRESSURES THEN PROFESSIONAL ADVICE FROM AN AUTHORISED INSTALLER IS RECOMMENDED TO FIT TESTED AND THIRD PARTY CERTIFIED AIR TRANSFER GRILLS AND/OR AUTOMATIC DOOR OPERATORS.
 NOTE: BC VALVES ARE DESIGNED TO ASSIST BACK-CHECK AND DO NOT REPLACE THE REQUIREMENT FOR CORRECTLY FITTED DOORSTOPS OR SAFETY BARRIERS.

FURTHER WARRANTY INFORMATION: <https://www.rutlanduk.co.uk/rutland-warranty>

BC - Back Check
 DA - Delay Action
 1 - Closing Speed
 2 - Latching Speed

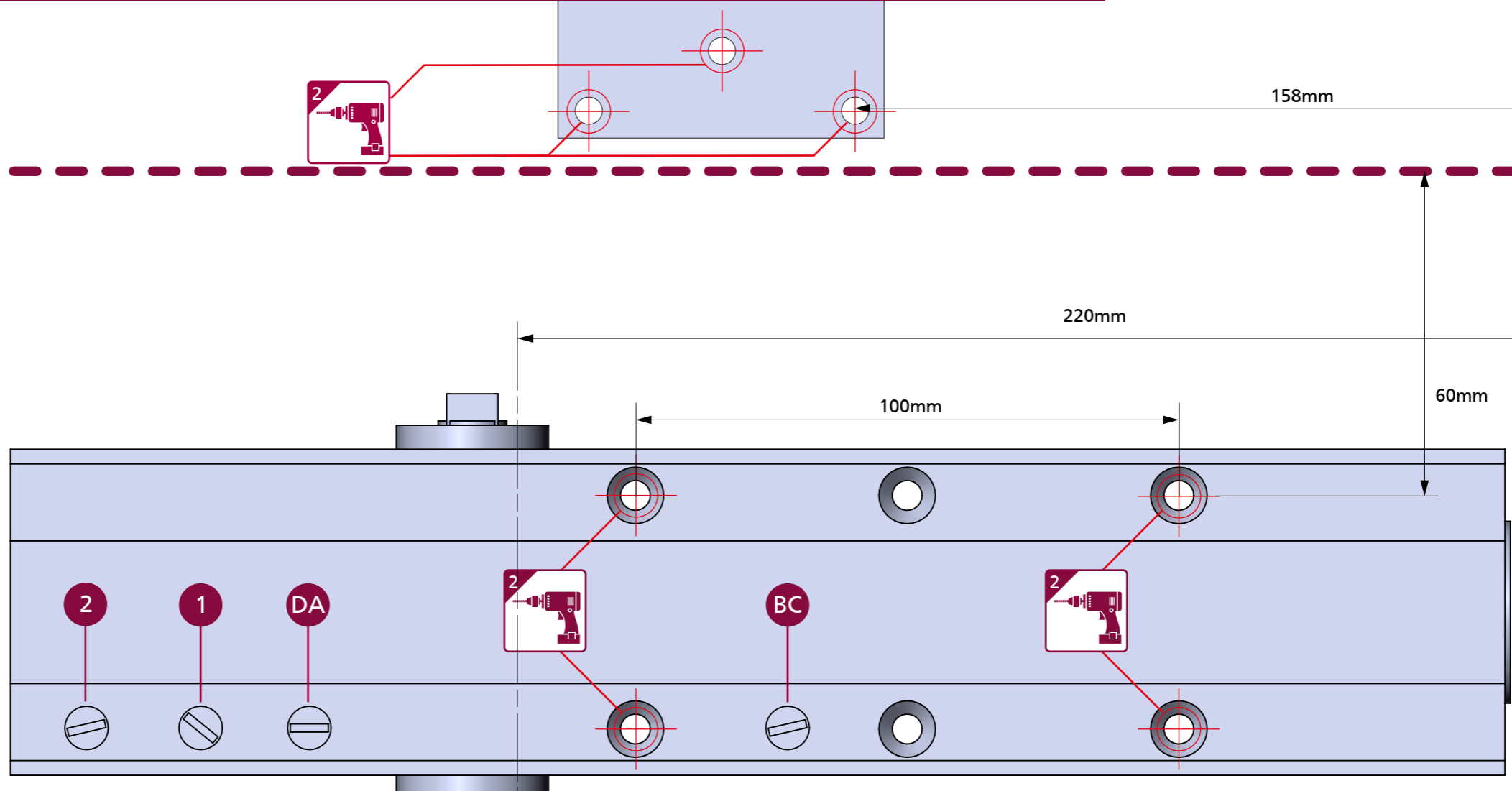

EN 2-6 Power Size

No of turns	EN Size	Max door width	Max open angle	Max weight
-4	2	850mm	180°	45
-2	3	950mm	180°	60
0*	4	1100mm	180°	80
+3	5	1250mm	180°	110
+8	6	1400mm	110°	120

*FACTORY PRE-SET

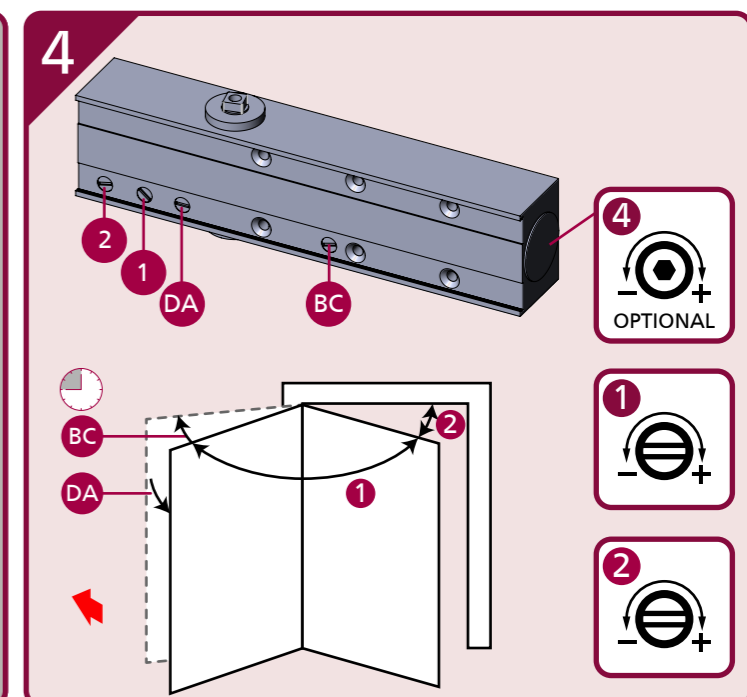
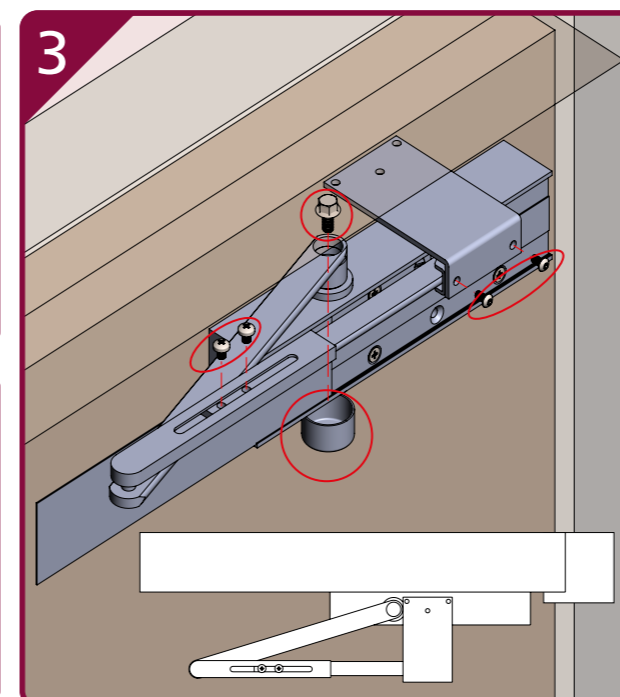
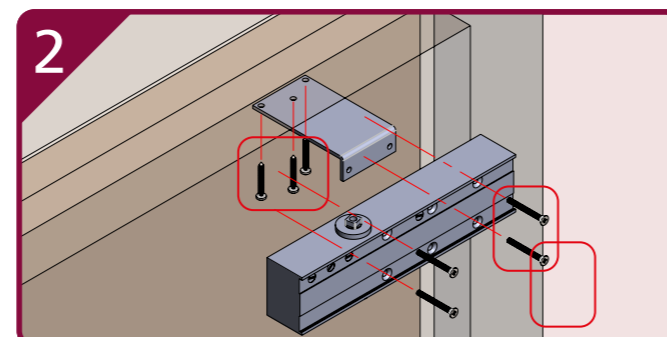
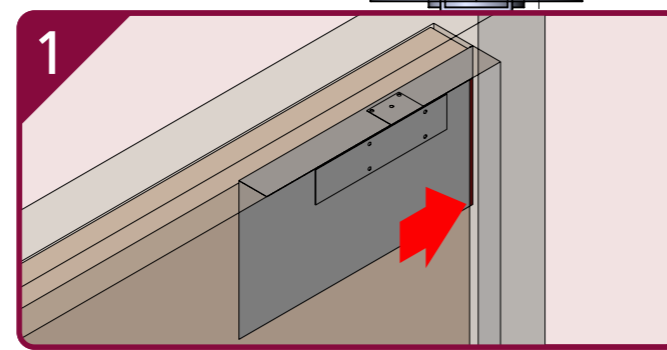



Parallel Arm Fig 6 (Push-side)

TS9206

TEL: +44 (0) 1246 261 491 | www.rutlanduk.co.uk



Operations and Maintenance Manual



3rd Party Certification



180° Open Angle



Two-Stage Speed Regulation



1812



1720



35 YEARS WARRANTY



1400mm Max door width



120Kg Max door weight

BS EN 1154

4 8 2 1 1 3

FOLD 1

FOLD 2

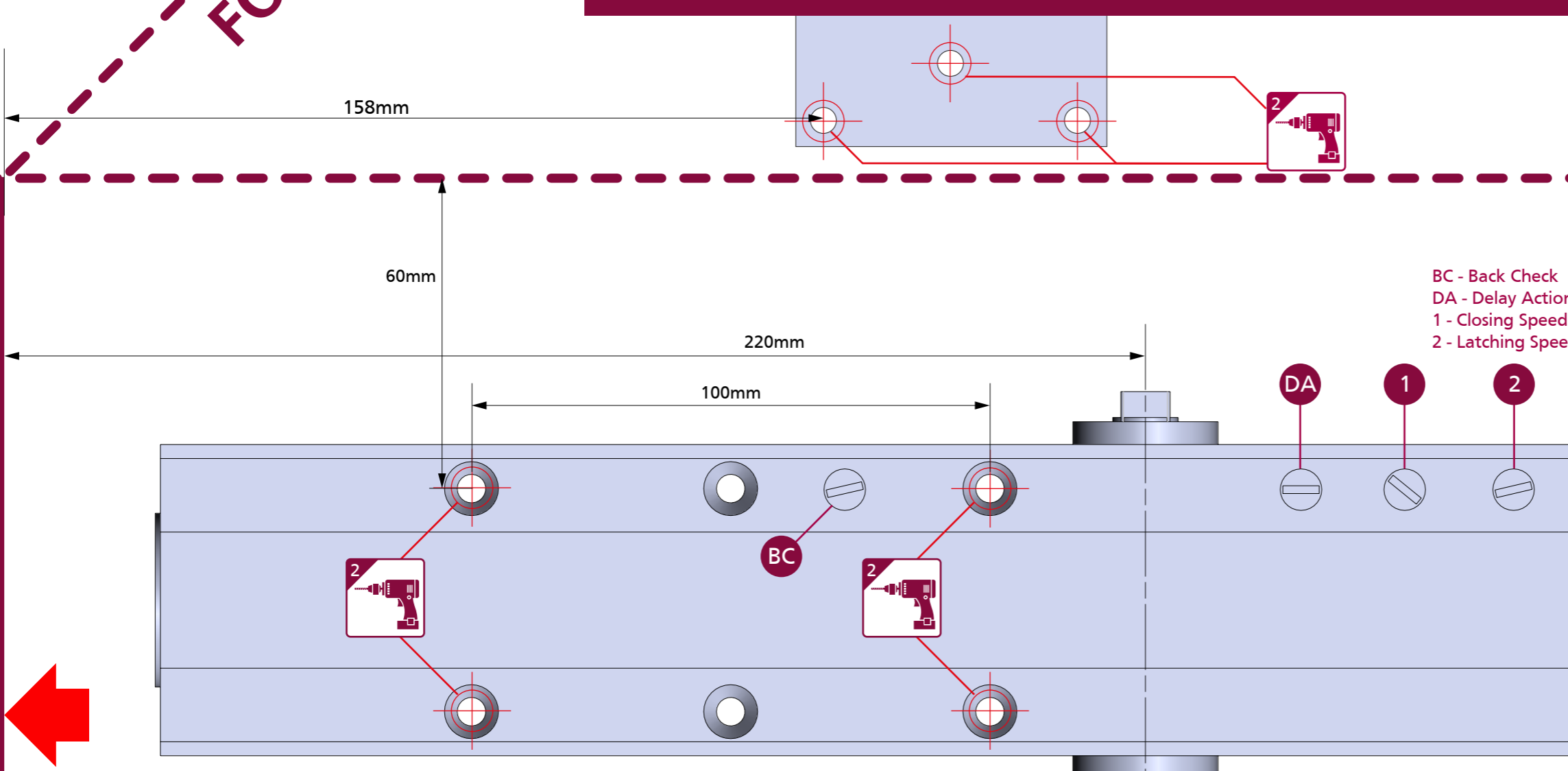

IMPORTANT NOTES:
 DELAYED ACTION & BACK CHECK (DABC) VALVES ARE NOT STANDARD, THESE ARE OPTIONAL. FOR UNINSULATED STEEL DOORS IP.95M MUST BE USED.
 THE PINION BOLT MUST BE TIGHTENED TO 12Nm.

A MECHANICAL DOOR CLOSER IS NOT DESIGNED TO OVERCOME POOR FITTING, EXCESSIVE AIR PRESSURES OR BINDING SMOKE AND WEATHER SEALS. EXCESSIVE AIR PRESSURES CAN BE CREATED BY THROUGH DRAFT, BY AIR CONDITIONING, BY SMALL ROOMS WITHOUT VENTILATION, OR WHERE NO AIR TRANSFER GRILLS ARE FITTED. MECHANICAL DOOR CLOSERS ARE DESIGNED TO CLOSE THE STATED AND TESTED SPECIFICATION OF DOOR WEIGHT AND DOORSETS/DOOR ASSEMBLIES WHEN DOORS ARE FITTED WITH CORRECT GAPS AND NOT BINDING ON SEALS. IF YOU ENCOUNTER PROBLEMS WITH DOORS NOT CLOSING PLEASE WATCH OUR "6 WAYS TO TROUBLESHOOT A DOOR CLOSER" VIDEO ONLINE. WHERE DOORS ARE NOT CLOSING DUE TO AIR PRESSURES THEN PROFESSIONAL ADVICE FROM AN AUTHORISED INSTALLER IS RECOMMENDED TO FIT TESTED AND THIRD PARTY CERTIFIED AIR TRANSFER GRILLS AND/OR AUTOMATIC DOOR OPERATORS.
 NOTE: BC VALVES ARE DESIGNED TO ASSIST BACK-CHECK AND DO NOT REPLACE THE REQUIREMENT FOR CORRECTLY FITTED DOORSTOPS OR SAFETY BARRIERS.

FURTHER WARRANTY INFORMATION: <https://www.rutlanduk.co.uk/rutland-warranty>

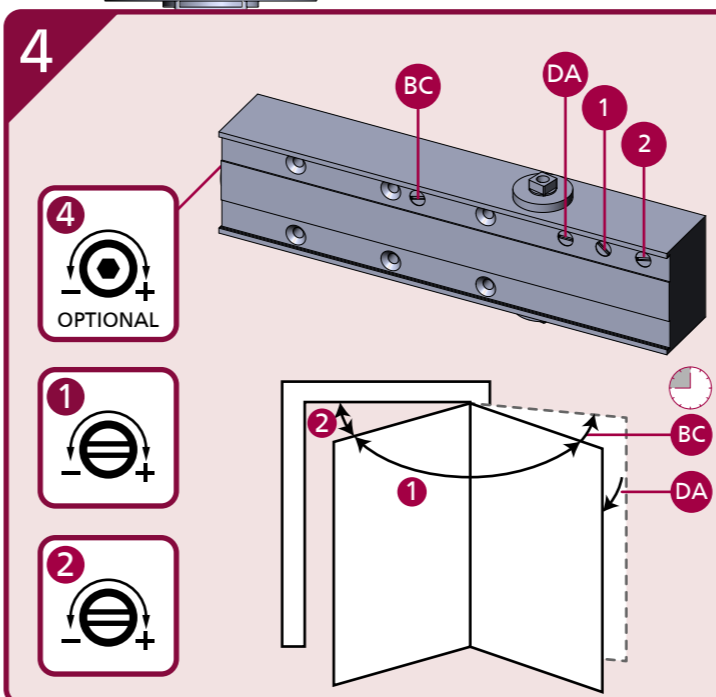
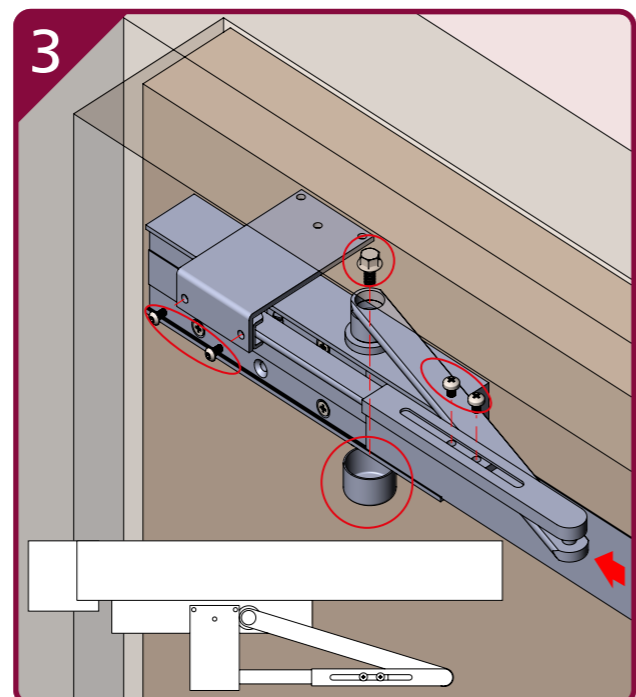
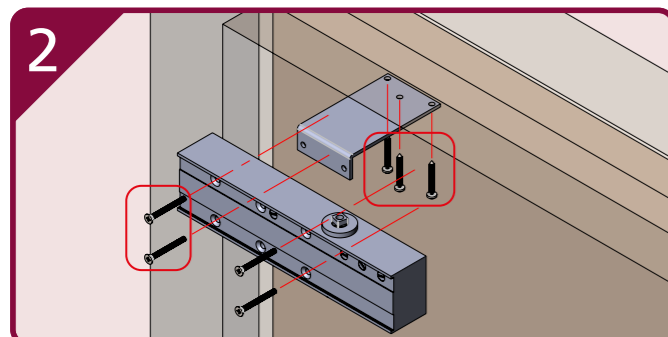
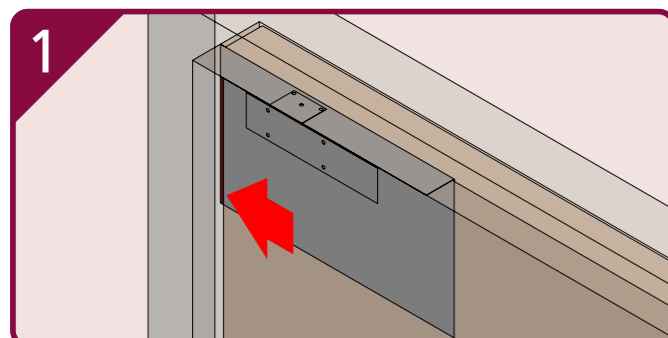

EN 2-6 Power Size

No of turns	EN Size	Max door width	Max open angle	Max weight
-4	2	850mm	180°	45
-2	3	950mm	180°	60
0*	4	1100mm	180°	80
+3	5	1250mm	180°	110
+8	6	1400mm	110°	120

*FACTORY PRE-SET

Maintenance

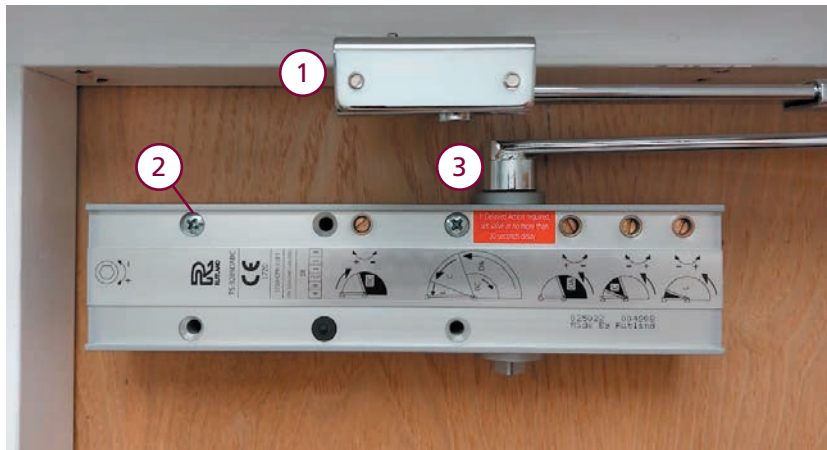
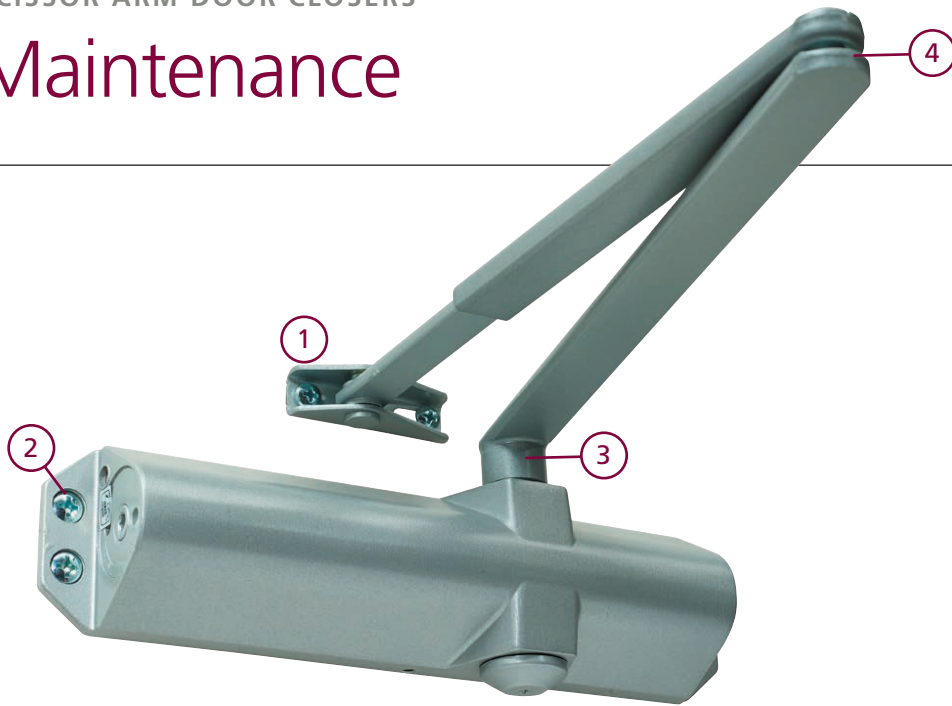

Step 1

Check that screws are tight (No.1 & No.2), and tighten if needed, at least every 6 months.

Step 2

Tighten pinion bolt (No. 3) to 12nm, at least every 6 months

Step 3

Lubricate all moving parts, e.g. the Knuckle (No.4), at least every 6 months.

*For high usage closers, this steps will need to be carried out more often than every 6 months.

Any unusual sounds or visual defects should be addressed immediately



Before adjusting any valves ensure the door and frame are fixed firmly and the door will close easily into the frame and latch.

- To increase the speed of a door turn the valve 1 (No.5) Anti-clockwise. If door closing too fast turn the valve 1 Clockwise to reduce the speed to a satisfactory movement.
- When the door is latching too fast adjust the valve 2 (No. 6) to the desired satisfactory action. Turn Clockwise to reduce the speed.
- If the latch is getting stuck, turn Valve 2 anti-clockwise to increase the speed but not too fast so that it slams.
- If more power is needed to overcome the latch or Intumescent seal you can increase the power by turning the power adjustment function (No. 7) with an allen key.
- If the door is too easy to open or affected by wind or air pressure, turn Clockwise to increase the power.
- If the door is stiff to open you can turn Anti-clockwise to decrease the power.

Back Check + Delayed Action on Scissor Arm closers

- If the closer has a back check valve (No. 8), this can be used to slow down the opening speed of the door. Turn the valve clockwise with a screwdriver to increase the Back Check facility.
- If the closer has a delayed action valve (No. 9), this can be used to delay the closing speed of the door. Turn the valve clockwise if more time is required or turn the valve anti-clockwise if less time is required.

IMPORTANT – Back Check and Delayed Action are not designed to work at the same time as each other, this means choosing the function most relevant to the situation

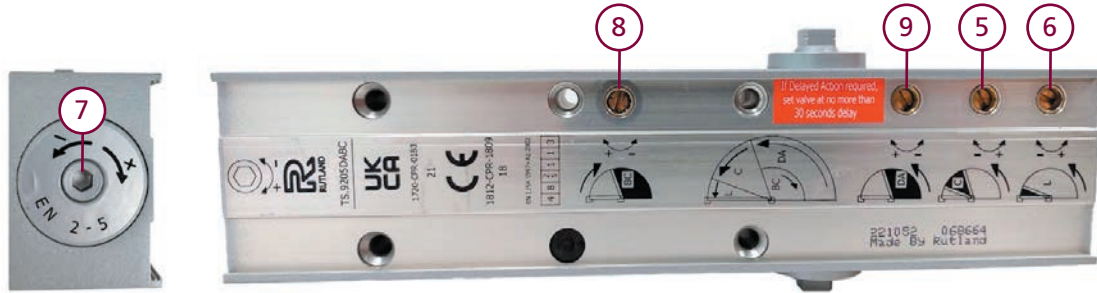

Before adjusting any valves ensure the door and frame are fixed firmly and the door will close easily into the frame and latch.

- To increase the speed of a door turn the valve 1 (No.5) Anti-clockwise. If door closing too fast turn the valve 1 Clockwise to reduce the speed to a satisfactory movement.
- When the door is latching too fast adjust the valve 2 (No. 6) to the desired satisfactory action. Turn Clockwise to reduce the speed.
- If the latch is getting stuck, turn Valve 2 anti-clockwise to increase the speed but not too fast so that it slams.
- If more power is needed to overcome the latch or Intumescent seal you can increase the power by turning the power adjustment function (No. 7) with an allen key.
- If the door is too easy to open or affected by wind or air pressure, turn Clockwise to increase the power.
- If the door is stiff to open you can turn Anti-clockwise to decrease the power.

Back Check + Delayed Action on Scissor Arm closers

- If the closer has a back check valve (No. 8), this can be used to slow down the opening speed of the door. Turn the valve clockwise with a screwdriver to increase the Back Check facility.
- If the closer has a delayed action valve (No. 9), this can be used to delay the closing speed of the door. Turn the valve clockwise if more time is required or turn the valve anti-clockwise if less time is required.

IMPORTANT – Back Check and Delayed Action are not designed to work at the same time as each other, this means choosing the function most relevant to the situation.



SCISSOR ARM DOOR CLOSERS

Back Check and Delayed Action

Rutland Back Check and Delayed Action door closers are the same as other closers, however with extra valves.

BC Valves

- BC valves are for the restraining of the door on the opening cycle, so it doesn't hit a wall or furniture behind the door.

DA Valves

- DA door closers are for giving the elderly, the infirm or children a little extra time when walking through the door way. Both valves can be altered to a greater or lesser degree as required.

Useful Videos

Scan the qr codes to view the latest helpful videos

Door closer valves



6 ways to trouble shoot a Door Closer



Enhancing life safety at every fire door

Through our expert advice and support, we provide the peace of mind that full compliance is achieved and that life safety is assured.



Head Office:

Rutland Trading Co Ltd.
Unit 4, Holmewood Business Park
Chesterfield Road, Holmewood
Chesterfield, S42 5US

Contact us:

+44 (0)1246 261491
sales@rutlanduk.co.uk
rutlanduk.co.uk