



Shear Lock

Fitting Instruction

TEL: +44 (0) 1246 261 491 | www.rutlanduk.co.uk

Component List:

TYPE	QTY
Screw M5x8	16pcs
Screw M5x25	8pcs
Screw M4x12	8pcs
M3 Socket key	1pcs
Shims	4pcs
Plastic Board	2pcs
Indicator Light Cap	1pcs
LED Connector	1pcs

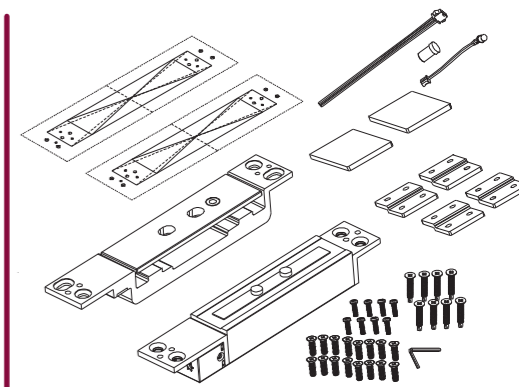

DIMENSIONS:

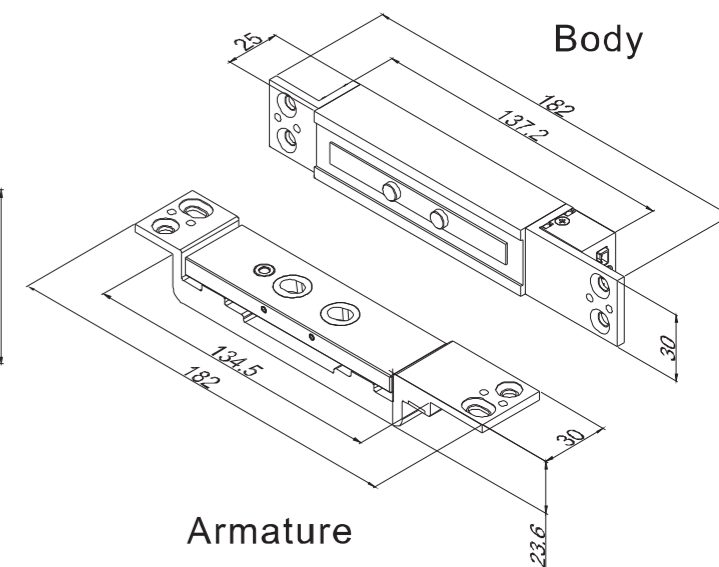
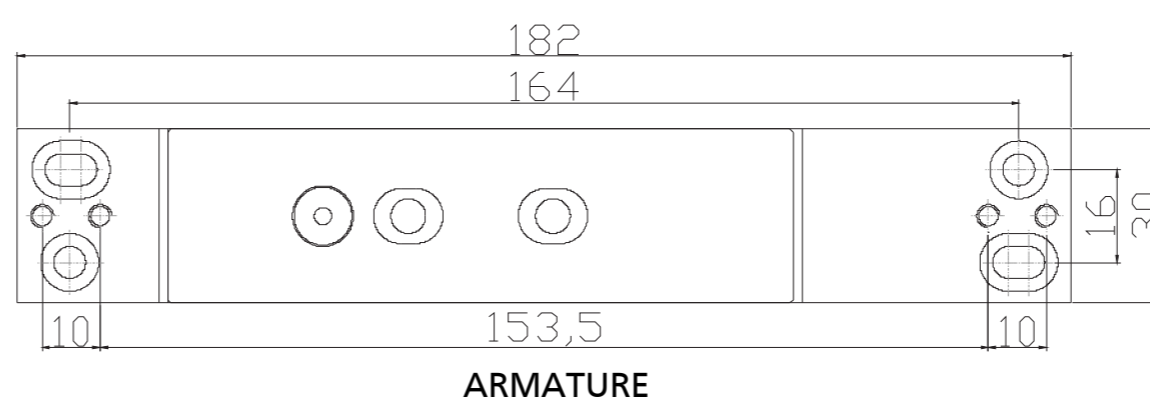
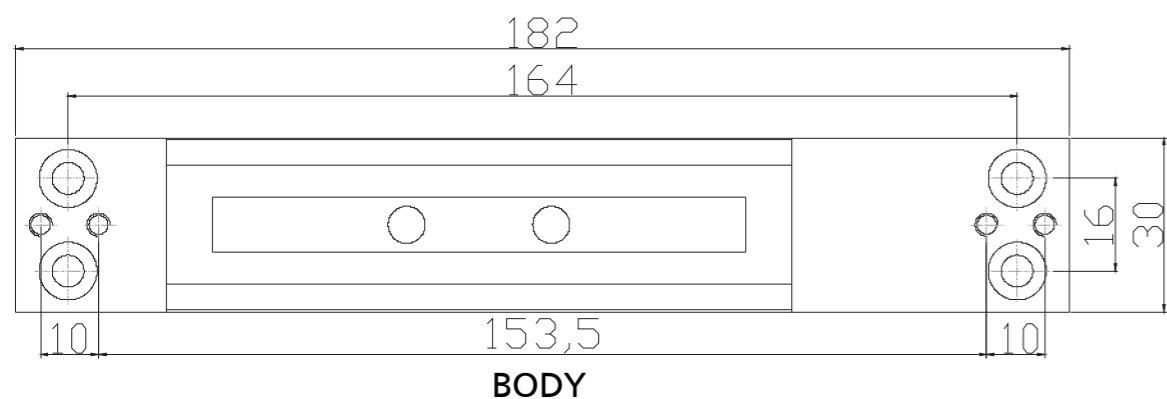

SPECIFICATIONS:

- 1.Compact size and easy to install.
- 2.Micro controller with door opening delay and door sensor output functions.
- 3.Suitable for 90°or 180°door open aluminum or wooden doors.
- 4.Relock function will activate to lock the door automatically (maximum 60 times per session) when the door is not locked properly.
- 5.Auto adjustable power supply 12/24V.
- 6.Maximum holding force up to 1200kg. Maximum magnetic distance up to 5mm (@24V).
- 7.Two long locking holes at cater corners of the armature are able to fine adjust both armature and body when they are installed.

		Notes
Power Input	DC 12V/ DC 24V	±15%
Operation Current	Operation Current:900mA(min) /12VDC Holding Current: 220mA/12VDC	± 5%
	Operation Current:900mA(min) /24VDC Holding Current: 190mA/24VDC	±5%
Monitor Output	N.O. & N.C.	Hall Effect Sensor
Operation Delay Time	0.5 Sec.- 25 Sec.	
Max. Shear Holding Force	1200Kg(2600lbs.)	
Operation Temperature	-30℃~50℃	
Warranty	1 year under normal circumstances	
Weight	1.2Kg	
Magnetic Distance(Max.)	3.0mm @12V / 5.0mm @24V	

CONNECTIONS:

Model	5 PIN	Model	2 PIN
Color		Color	
Brown	GND -	Black	Status LED Output
Red	VCC +	Brown	Status LED Output
Orange	Door Positions Sensor N.O.		
Yellow	Door Positions Sensor COM.		
Green	Door Positions Sensor N.C.		

WIRE DIAGRAM

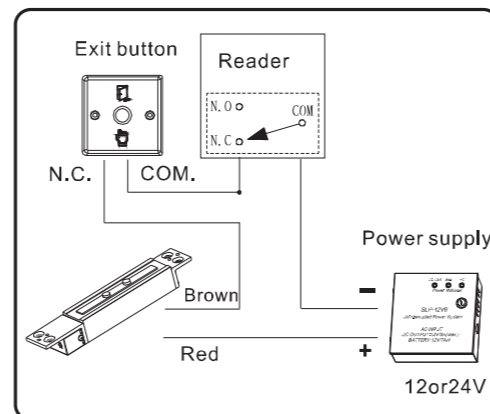

PANEL DIAGRAM

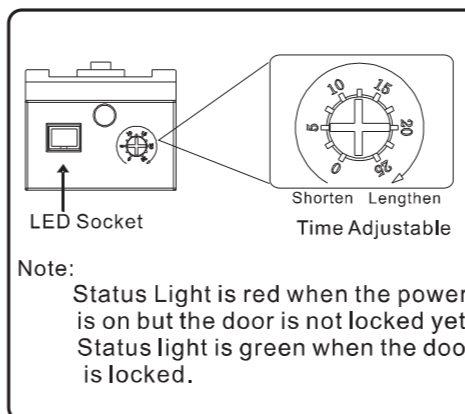

Please check before installation:

- 1.Please make sure the inner width and depth of door frame and door leaf (hollow metal door)are wide and deep enough to install the lock. Make sure the closing position of the door leaf is at the accurate place to enable the shear lock to lock accurately. Door closer is able to place the door leaf's closing position back to the accurate place to avoid other factor such as wind.
- 2.Minimun 900mA@DC12V/24V of current is required to activate shear lock. When it is locked, current will drop to 220mA@DC12V or 190mA@DCV24V. Therefore ,current has to meet the standard of 1A and above to supply to the shear lock.

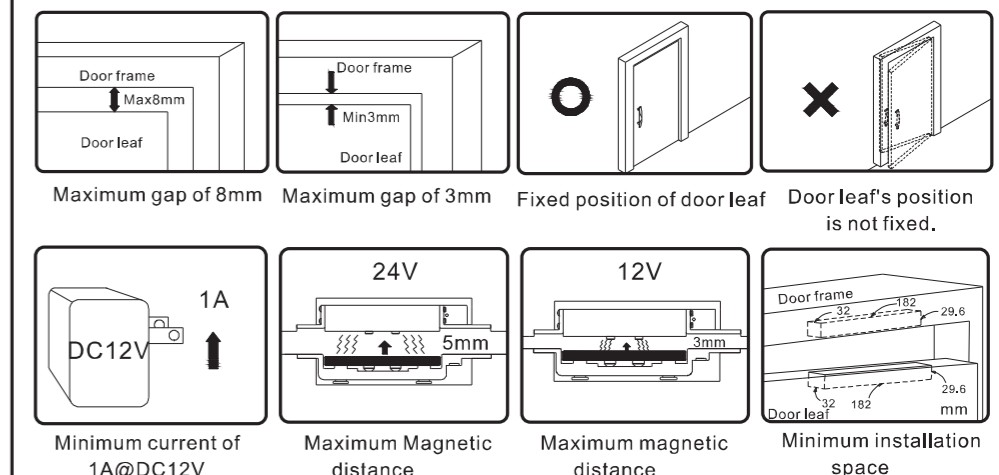

FIXING HOLES for SOLID DOORS:
Installation of the lock and screws are different for solid doors and hollow doors

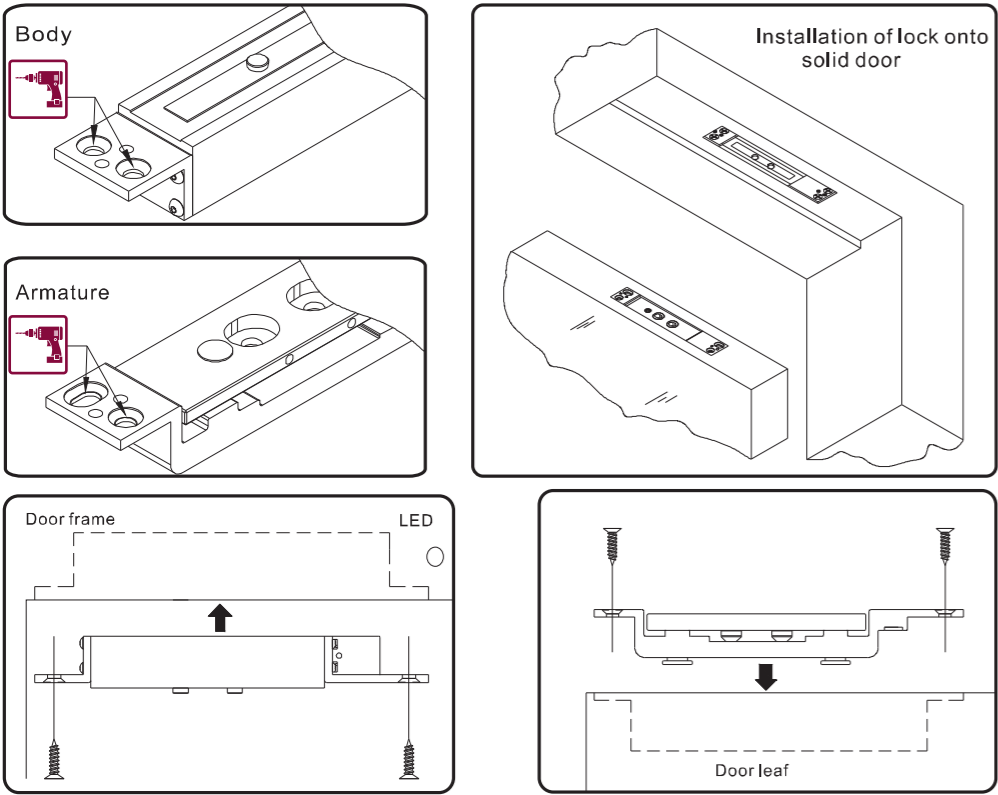

FIXING HOLES for SOLID DOORS:
Installation of the lock and screws are different for solid doors and hollow doors

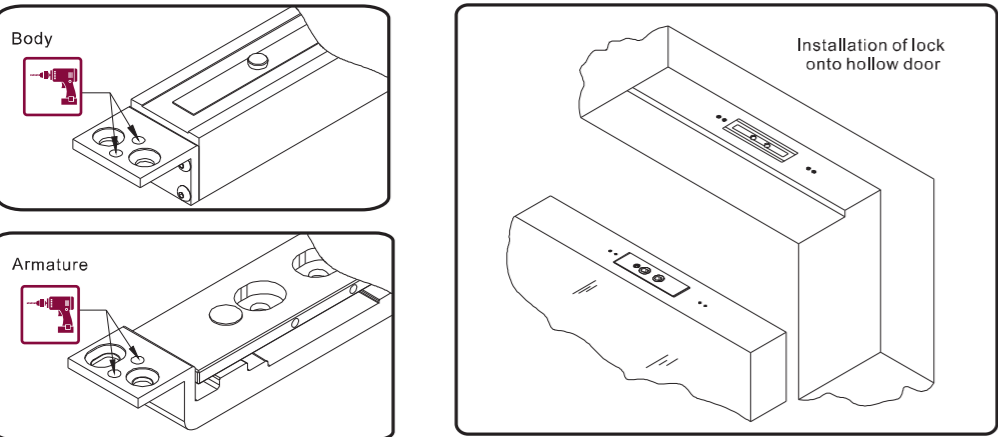

SITUATION 1: When the distance between door frame and door leaf is too small

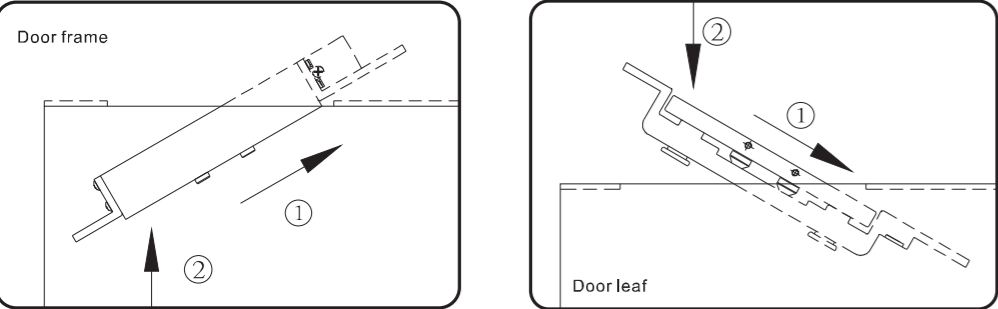

SITUATION 2: Use of templates

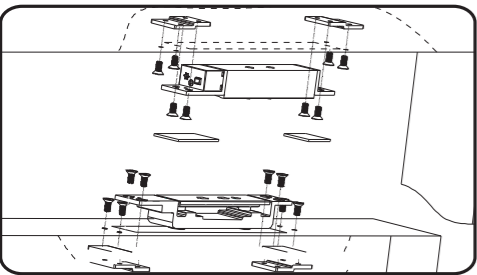

Installation of lock with template

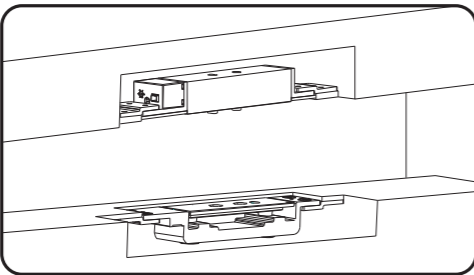

INSTALLATIONS:

Step 1: Confirm installation position
It can be installed either on the top of the door.

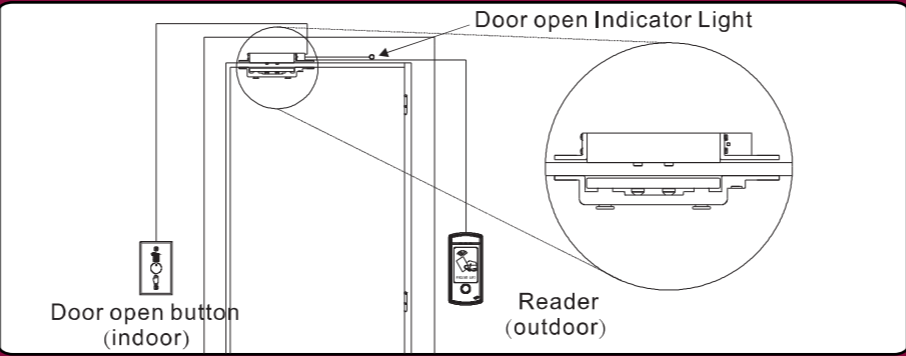

Step 2: Place sticker in confirmed position
Please make sure both top and bottom stickers' position lines are

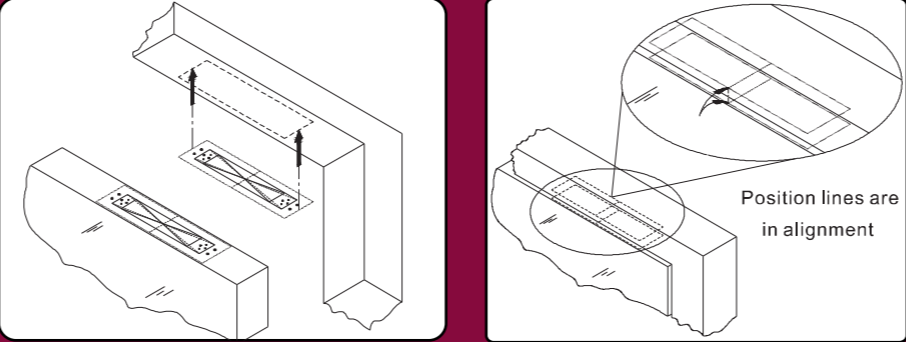

Step 3: Cut or Knockout
Cut (metal frame) or knockout (wooden frame) and, drill a hole on the door frame for the indicator light next to the lock.

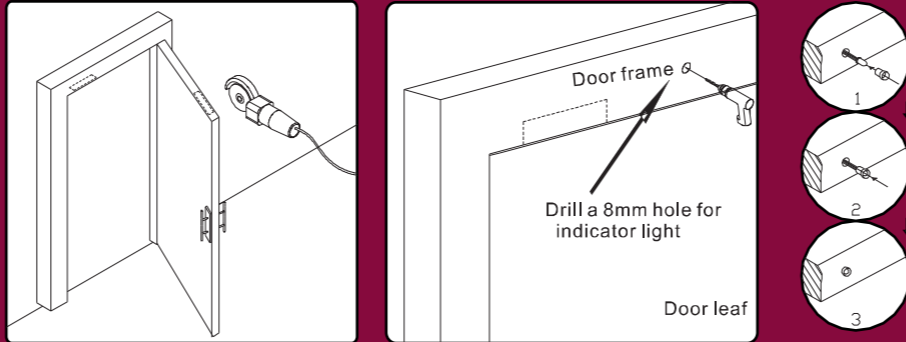

NOTICE

Maximum magnetic distance between the armature and lock body is 3mm@12V or 5mm @24V.
Use Hex key to adjust the armature.
Please make sure the distance between the armature and the lock is even and not tilted or uneven.

Step 4: Wiring
Install the indicator light at the door frame and connect 5PIN connector with other wires. (Please refer to P2 for connector points)

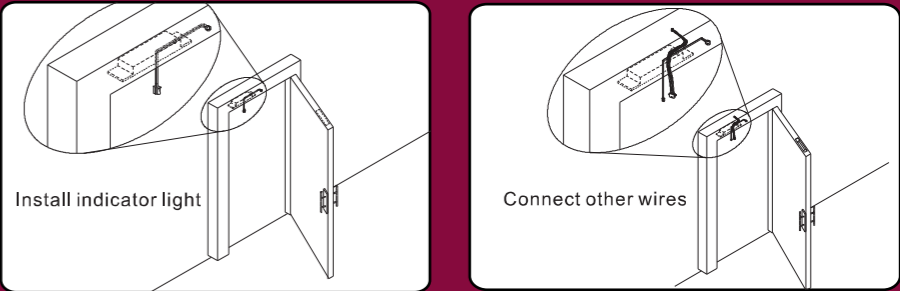

Step 5: Fixing the lock and the armature
Connecting all wires to shear lock body. Adjusting required door open delay time and finally fixing both lock and armature.

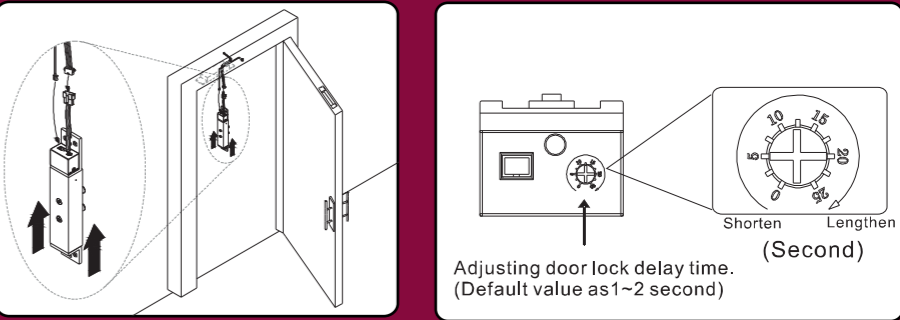

Step 6: Current and fine-adjustment
Turn on the power and close the door to check if the lock is functioning properly. Please fine-adjust the armature if it is unable to lock properly. Please refer to Trouble Shootings for other problems.

